

# WELD FITTINGS

Weld to the ASTM A270 tubing

1.1



Removal from the system is not required  
EACH FITTINGS PACKAGING HAS A BARCODE

1.1

**WELD FITTINGS....**

Weld fittings give processors the highest degree of corrosion resistance and sanitation available. Their streamlined design, flush joints and butt-weld assembly provides full, unrestricted flow for truly hygienic, permanent welded systems.

**GEMO** Weld Fittings meet



**WELD FITTINGS SPECIFICATIONS....**

Size Range: 1/2" OD through 12" OD  
 Materials: T304, T316L  
 Surface Finish:  
 Mechanically Polished  
 Internal 20Ra (0.51µm), External 32Ra (0.8µm)  
 No. 7 - ID & OD  
 No. 5 - OD only  
 No. 3 - ID only  
 No. 1 - unpolished  
 Custom - built upon request

**ORDERING SPECIFICATIONS....**

- Specify:
- Description
  - Item No.
  - Size
  - Material
  - Surface Polish Requirements
  - Quantity

**Example**

Description	Item No	Size	Material	Surface	Quantity
A2WK bend	5025	2"	T304	NO.7	200

**NOTES THE DIMENSION TABLES**

- All Dimensions are in mm.
- Wall Thickness: Fittings 1.0"-3.0" sizes are manufactured with 16 gauge (0.065") wall thickness. The 4.0" tube size is manufactured with 14 gauge (0.083") wall thickness.

# Weld Fittings

Part for ASTM A270 tubes



## TUBES AND FITTINGS **GEMO**

Finish: OD: Semi bright. ID: Mirror  
Connections: Welding ends

1.1

### A2WK Bend 45°, No Tangent

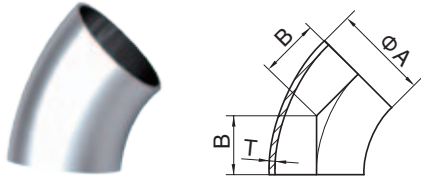

#### Basic Ordering Number: 5025

NO,	Size	A	B	T
5025 0100	1.0"	25.4	15.8	1.65
5025 0150	1.5"	38.1	23.8	1.65
5025 0200	2.0"	50.8	31.75	1.65
5025 0250	2.5"	63.5	39.6	1.65
5025 0300	3.0"	76.2	47.6	1.65
5025 0400	4.0"	101.6	63.5	2.11

\*\*T304 and T316L are available.

### AL2WS Bend 45°

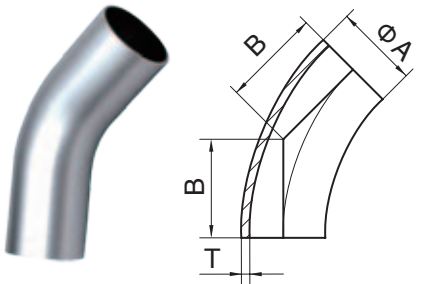

#### Basic Ordering Number: 5026

NO.	Size	A	B	T
5026 0100	1.0"	25.4	30.2	1.65
5026 0150	1.5"	38.1	41.3	1.65
5026 0200	2.0"	50.8	58.7	1.65
5026 0250	2.5"	63.5	76.2	1.65
5026 0300	3.0"	76.2	93.7	1.65
5026 0400	4.0"	101.6	122.2	2.11

\*\*T304 and T316L are available.

### A2WCL Bend 90°, No Tangent

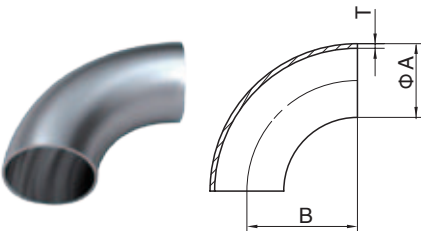

#### Basic Ordering Number: 5027

NO.	Size	A	B	T
5027 0100	1.0"	25.4	38.1	1.65
5027 0150	1.5"	38.1	57.2	1.65
5027 0200	2.0"	50.8	76.2	1.65
5027 0250	2.5"	63.5	95.25	1.65
5027 0300	3.0"	76.2	114.3	1.65
5027 0400	4.0"	101.6	152.4	2.11

\*\*T304 and T316L are available.

NOTE! Treatment: Annealed.

\*\*All measurements are in millimeters (mm)  
Conversion to inches, 25.4mm=1inch

# Weld Fittings

Part for ASTM A270 tubes



TUBES AND FITTINGS **GEMO**

Finish: OD: Semi bright. ID: Mirror  
Connections: Welding ends

1.1

## AL2S Bend 90°

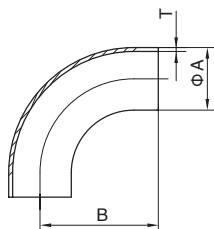

### Basic Ordering Number: 5028

NO.	Size	A	B	T
5028 0100	1.0"	25.4	52.4	1.65
5028 0150	1.5"	38.1	74.6	1.65
5028 0200	2.0"	50.8	103.2	1.65
5028 0250	2.5"	63.5	131.8	1.65
5028 0300	3.0"	76.2	160.3	1.65
5028 0400	4.0"	101.6	211.1	2.11

\*\*T304 and T316L are available.

## AL7WWW Equal Tee, No Tangent

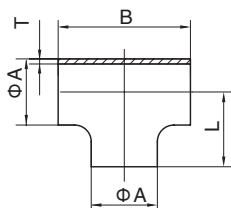
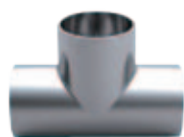

### Basic Ordering Number: 5029

NO.	Size	A	B	L	T
5029 0100	1.0"	25.4	57.2	28.6	1.65
5029 0150	1.5"	38.1	84.2	42.1	1.65
5029 0200	2.0"	50.8	104.8	52.4	1.65
5029 0250	2.5"	63.5	119.0	59.5	1.65
5029 0300	3.0"	76.2	131.8	65.9	1.65
5029 0400	4.0"	101.6	174.6	87.3	2.11

\*\*T304 and T316L are available.

## A7W Equal Tee

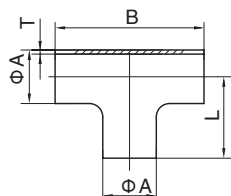
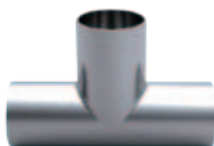

### Basic Ordering Number: 5030

NO.	Size	A	B	L	T
5030 0100	1.0"	25.4	95.2	47.6	1.65
5030 0150	1.5"	38.1	114.3	57.2	1.65
5030 0200	2.0"	50.8	152.4	76.2	1.65
5030 0250	2.5"	63.5	152.4	76.2	1.65
5030 0300	3.0"	76.2	165.2	82.6	1.65
5030 0400	4.0"	101.6	196.8	98.4	2.11

\*\*T304 and T316L are available.

NOTE! Treatment: Annealed.

\*\*All measurements are in millimeters (mm)  
Conversion to inches, 25.4mm=1inch

# Weld Fittings

Part for ASTM A270 tubes



Finish: OD: Semi bright. ID: Mirror  
Connections: Welding ends

## AL7RW Reducing Tee

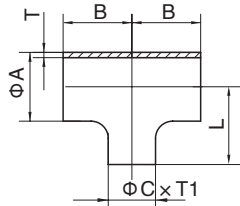
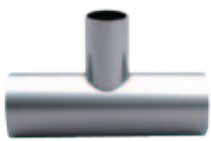

### Basic Ordering Number: 5031

NO.	Size	A	C	B	L	T	T1
5031 01510	1.5"×1.0"	38.1	25.4	57.15	53.98	1.65	1.65
5031 02010	2.0"×1.0"	50.8	25.4	76.2	60.30	1.65	1.65
5031 02015	2.0"×1.5"	50.8	38.1	76.2	63.50	1.65	1.65
5031 02515	2.5"×1.5"	63.5	38.1	76.2	69.85	1.65	1.65
5031 02520	2.5"×2.0"	63.5	50.8	76.2	82.55	1.65	1.65
5031 03015	3.0"×1.5"	76.2	38.1	82.55	76.2	1.65	1.65
5031 03020	3.0"×2.0"	76.2	50.8	82.55	88.9	1.65	1.65
5031 03025	3.0"×2.5"	76.2	63.5	82.55	82.55	1.65	1.65
5031 04020	4.0"×2.0"	101.6	50.8	98.4	101.6	2.11	1.65
5031 04025	4.0"×2.5"	101.6	63.5	98.4	95.25	2.11	1.65
5031 04030	4.0"×3.0"	101.6	76.2	98.4	95.25	2.11	1.65

\*\*T304 and T316L are available.

## A9WWWW Equal Cross

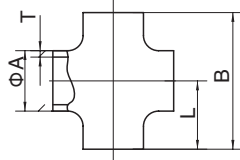

### Basic Ordering Number: 5032

NO.	Size	A	B	L	T
5032 0100	1.0"	25.4	57.2	28.6	1.65
5032 0150	1.5"	38.1	84.2	42.1	1.65
5032 0200	2.0"	50.8	104.6	52.4	1.65
5032 0250	2.5"	63.5	119.0	59.5	1.65
5032 0300	3.0"	76.2	131.8	65.9	1.65
5032 0400	4.0"	101.6	174.6	87.3	2.11

\*\*T304 and T316L are available.

## L31 Concentric Reducer

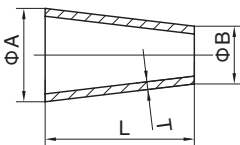

### Basic Ordering Number: 5033

NO.	Size	A	B	L	T
5033 01510	1.5"×1.0"	38.1	25.4	50.8	1.65
5033 02010	2.0"×1.0"	50.8	25.4	101.6	1.65
5033 02015	2.0"×1.5"	50.8	38.1	50.8	1.65
5033 02510	2.5"×1.0"	63.5	25.4	152.4	1.65
5033 02515	2.5"×1.5"	63.5	38.1	101.6	1.65
5033 02520	2.5"×2.0"	63.5	50.8	50.8	1.65
5033 03010	3.0"×1.0"	76.2	25.4	203.2	1.65
5033 03015	3.0"×1.5"	76.2	38.1	152.4	1.65
5033 03020	3.0"×2.0"	76.2	50.8	101.6	1.65
5033 03025	3.0"×2.5"	76.2	63.5	50.8	1.65
5033 04015	4.0"×1.5"	101.6	38.1	254.0	2.11
5033 04020	4.0"×2.0"	101.6	50.8	203.2	2.11
5033 04025	4.0"×2.5"	101.6	63.5	152.4	2.11
5033 04030	4.0"×3.0"	101.6	76.2	101.6	2.11

\*\*T304 and T316L are available.

NOTE! Treatment: Annealed.

\*\*All measurements are in millimeters (mm)  
Conversion to inches, 25.4mm=1inch

# Weld Fittings

Part for ASTM A270 tubes

Finish: OD: Semi bright. ID: Mirror  
Connections: Welding ends



1.1

## L32 Eccentric Reducer

Basic Ordering Number: 5034

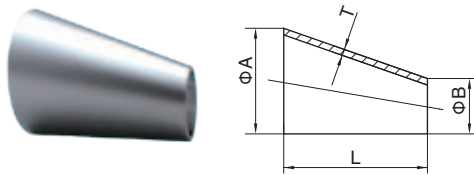

NO.	Size	A	B	L	T
5034 01510	1.5"×1.0"	38.1	25.4	50.8	1.65
5034 02010	2.0"×1.0"	50.8	25.4	101.6	1.65
5034 02015	2.0"×1.5"	50.8	38.1	50.8	1.65
5034 02510	2.5"×1.0"	63.5	25.4	152.4	1.65
5034 02515	2.5"×1.5"	63.5	38.1	101.6	1.65
5034 02520	2.5"×2.0"	63.5	50.8	50.8	1.65
5034 03010	3.0"×1.0"	76.2	25.4	203.2	1.65
5034 03015	3.0"×1.5"	76.2	38.1	152.4	1.65
5034 03020	3.0"×2.0"	76.2	50.8	101.6	1.65
5034 03025	3.0"×2.5"	76.2	63.5	50.8	1.65
5034 04015	4.0"×1.5"	101.6	38.1	254.0	2.11
5034 04020	4.0"×2.0"	101.6	50.8	203.2	2.11
5034 04025	4.0"×2.5"	101.6	63.5	152.4	2.11
5034 04030	4.0"×3.0"	101.6	76.2	101.6	2.11

\*\*T304 and T316L are available.

\*\*All measurements are in millimeters (mm)  
Conversion to inches, 25.4mm=1inch

## P&E Flow Technology Profile

P&E Flow Technology is provider of professional products for the fluid industry and related solutions.

We are committed to brew processing, beverage processing, Dairy and Foodstuff processing, pharmaceutical industry, water treatment works, Bio-engineering and fluid technology industry

## P&E Flow Technology Brands

**CKAN**

**ZIMANI**

**GEMO**

**Meatier**

**Shst**

How to contact P&E Flow Technology  
[www.pestainless.com](http://www.pestainless.com)

GEMO Products Services  
Please visit and contact us:  
[www.gemoindustries.com](http://www.gemoindustries.com)

Technical Support  
[Tech@gemoindustries.com](mailto:Tech@gemoindustries.com)

Service  
[Info@gemoindustries.com](mailto:Info@gemoindustries.com)

Dealer Management  
[DealerManagement@gemoindustries.com](mailto:DealerManagement@gemoindustries.com)

## P&E Flow Technology

Address: Shacheng Street, WenZhou, P.R China.  
Post Code: 325000

Service, Sales  
Tel: +86-577-85826961  
Email: [Info@pestainless.com](mailto:Info@pestainless.com)

Dealer Management  
Email: [DealerManagement@pestainless.com](mailto:DealerManagement@pestainless.com)

Copyright © 2011 P&E

GEMO is a trademark registered and owned by P&E Flow Technology. P&E reserves the right to change specifications without prior notify action.