



1.2 SANITARY DIN

Catalog



Table of Contents page 27—50

FITTINGS DIN11852/DIN11850

Introduction & Order Information

Bends

6009 D2WK.....	29
6010 N2WK.....	29
6011 DL2WS.....	29
6012 NL2WS.....	30
6013 D2WCL.....	30
6014 N2WCL.....	30
6015 DL2WS.....	31
6016 NL2WS.....	31
6017 D3WS.....	31
6018 N3WS.....	32

Tees

6019 D7W.....	32
6020 N7W.....	32
6021 DL7WWW.....	33
6022 NL7WWW.....	33
6023 DL7W.....	34
6024 NL7W.....	35
6025 D7W.....	36
6026 N7W.....	37

Reducers

6027 DL31.....	38
6028 DL32.....	39

CLMAP UNION DIN32676

Ferrules

6029 D14AM.....	41
6030 N14AM.....	41

Gaskets

6031 40MP.....	41
----------------	----

Solid End Caps

6032 16AMP.....	42
-----------------	----

Clamps

6033 13MHM.....	42
-----------------	----

UNIONS DIN11851/ DIN11850

Introduction & Order Information

6034 DIN-13	45
6035 DIN-14	45
6036 DIN-15	45
6037 DIN-16	46
6038 DIN-14H	46
6039 DIN-15H	46
6040 DIN-14S	47
6041 DIN-15S	47
6042 DIN-14P	47
6043 DIN-15P	48
6044 DIN-14T	48
6045 DIN-15T	48
6046 DIN-14B	49
6047 DIN-13RS	49
6048 DIN-13RB	49
6049 DIN-13RBN	50
6050 P-16	50



Fittings

DIN11852/DIN11850

Weld to the DIN11850 and DIN11852 tubes

1.2



All bends, tees, and reducers are according to DIN11850/ DIN11852
EACH FITTINGS PACKAGING HAS A BARCODE

Fittings DIN11852/DIN11850

The hygienic Tubes, bends, Tee, Reducers, And Clamp Union of GEMO are strictly according to Germany DIN11850, DIN32676 Standard, Gaskets for Clamp Fittings are available in several different materials, EPDM, Silicone, FPM, and PTFE.

GEMO DIN fittings meet

DIN requirements.

FITTINGS DIN11852/DIN11850

FITTINGS SPECIFICATIONS....

Size Range: DN10 ID through DN200 ID
Materials: 1.4301(304), 1.4404(316L)
Surface Finish:
Mechanically Polished
Internal 20Ra (0.51µm), External 32Ra (0.8µm)
No. 7 - ID & OD
No. 5 - OD only
No. 3 - ID only
No. 1 - unpolished
Custom - built upon request

ORDERING SPECIFICATIONS....

- Specify:
- Description
 - Code No.
 - Size
 - Material
 - Surface Polish Requirements
 - Quantity



Description	Code No	Size	Material	Surface	Quantity
D2WK	6009	DN50	1.4301	NO.7	500

NOTES THE DIMENSION TABLES

- All Dimensions are according to DIN standard.
- Wall Thickness: Fittings DN15-DN50 sizes are manufactured with 1.5 mm wall thickness. The DN65-DN200 tube size are manufactured with 2mm wall thickness

DIN11852/DIN11850

Part for DIN tubes



TUBES AND FITTINGS **GEMO**

Finish: OD: Semi bright. ID: Mirror
Connections: Welding ends

1.2

D2WK Bend 45°, acc to DIN 11852

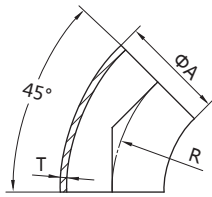

Basic Ordering Number: 6009

NO.	DN	A	R	T
6009 01000	10	13	26	1.5
6009 01500	15	19	35	1.5
6009 02000	20	23	40	1.5
6009 02500	25	29	50	1.5
6009 03200	32	35	55	1.5
6009 04000	40	41	60	1.5
6009 05000	50	53	70	1.5
6009 06500	65	70	80	2.0
6009 08000	80	85	90	2.0
6009 10000	100	104	100	2.0
6009 12500	125	129	187.5	2.0
6009 15000	150	154	225	2.0
6009 20000	200	204	300	2.0

**1.4301 and 1.4404 are available.

N2WK Bend 45°

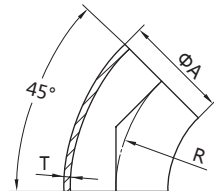

Basic Ordering Number: 6010

NO.	DN	A	R	T
6010 01000	10	12	26	1.5
6010 01500	15	18	35	1.5
6010 02000	20	22	40	1.5
6010 02500	25	28	50	1.5
6010 03200	32	34	55	1.5
6010 04000	40	40	60	1.5
6010 05000	50	52	70	1.5

**1.4301 and 1.4404 are available.

DL2WS EXPANDING Bend 45°, acc to DIN 11852

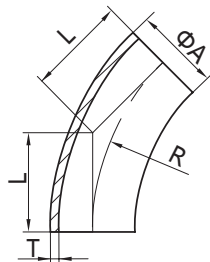

Basic Ordering Number: 6011

NO.	DN	A	R	L	T
6011 01000	10	13	26	35.8	1.5
6011 01500	15	19	35	39.5	1.5
6011 02000	20	23	40	41.6	1.5
6011 02500	25	29	50	60.7	1.5
6011 03200	32	35	55	62.8	1.5
6011 04000	40	41	60	64.9	1.5
6011 05000	50	53	70	69	1.5
6011 06500	65	70	80	73.0	2.0
6011 08000	80	85	90	92.3	2.0
6011 10000	100	104	100	96.4	2.0
6011 12500	125	129	187.5	135.2	2.0

**1.4301 and 1.4404 are available.

NOTE! Treatment: Annealed.

**All measurements are in millimeters (mm)
Conversion to inches, 25.4mm=1inch

DIN11852/DIN11850

Part for DIN tubes



Finish: OD: Semi bright. ID: Mirror
Connections: Welding ends

1.2

NL2WS EXPANDING Bend 45°

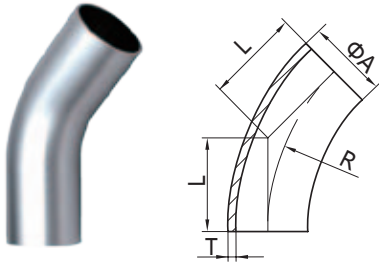

Basic Ordering Number: 6012

NO.	DN	A	R	L	T
6012 01000	10	12	26	35.8	1.5
6012 01500	15	18	35	39.5	1.5
6012 02000	20	22	40	41.6	1.5
6012 02500	25	28	50	60.7	1.5
6012 03200	32	34	55	62.8	1.5
6012 04000	40	40	60	64.9	1.5
6012 05000	50	52	70	69	1.5

**1.4301 and 1.4404 are available.

D2WCL Bend 90°, acc. to DIN 11852

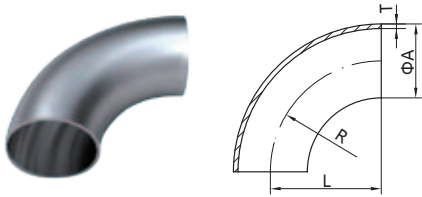

Basic Ordering Number: 6013

NO.	DN	A	R	L	T
6013 01000	10	13	26	26	1.5
6013 01500	15	19	35	35	1.5
6013 02000	20	23	40	40	1.5
6013 02500	25	29	50	50	1.5
6013 03200	32	35	55	55	1.5
6013 04000	40	41	60	60	1.5
6013 05000	50	53	70	70	1.5
6013 06500	65	70	80	80	2.0
6013 08000	80	85	90	90	2.0
6013 10000	100	104	100	100	2.0
6013 12500	125	129	187.5	187.5	2.0
6013 15000	150	154	225	225	2.0
6013 20000	200	204	300	300	2.0

**1.4301 and 1.4404 are available.

N2WCL Bend 90°

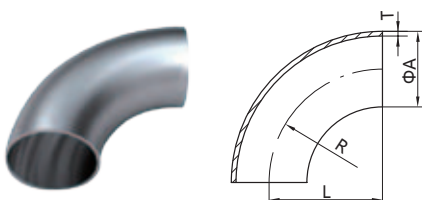

Basic Ordering Number: 6014

NO.	DN	A	R	L	T
6014 01000	10	12	26	26	1.5
6014 01500	15	18	35	35	1.5
6014 02000	20	22	40	40	1.5
6014 02500	25	28	50	50	1.5
6014 03200	32	34	55	55	1.5
6014 04000	40	40	60	60	1.5
6014 05000	50	52	70	70	1.5

**1.4301 and 1.4404 are available.

NOTE! Treatment: Annealed.

**All measurements are in millimeters (mm)
Conversion to inches, 25.4mm=1inch

DIN11852/DIN11850

Part for DIN tubes



TUBES AND FITTINGS **GEMO**

Finish: OD: Semi bright. ID: Mirror
Connections: Welding ends

1.2

DL2WS EXPANDING Bend 90°, acc to DIN 11852

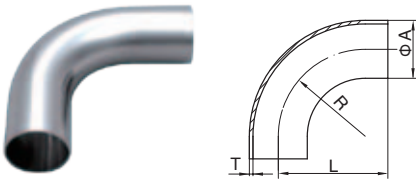

Basic Ordering Number: 6015

NO.	DN	A	R	L	T
6015 01000	10	13	26	38	1.5
6015 01500	15	19	35	47	1.5
6015 02000	20	23	40	52	1.5
6015 02500	25	29	50	70	1.5
6015 03200	32	35	55	78	1.5
6015 04000	40	41	60	85	1.5
6015 05000	50	53	70	97	1.5
6015 06500	65	70	80	110	2.0
6015 08000	80	85	90	118	2.0
6015 10000	100	104	100	140	2.0
6015 12500	125	129	187.5	245	2.0

**1.4301 and 1.4404 are available.

NL2WS EXPANDING Bend 90°

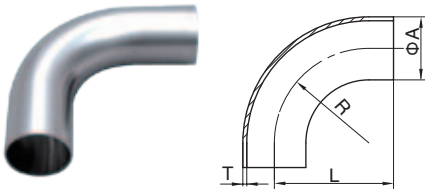

Basic Ordering Number: 6016

NO.	DN	A	R	L	T
6016 01000	10	12	26	38	1.5
6016 01500	15	18	35	47	1.5
6016 02000	20	22	40	52	1.5
6016 02500	25	28	50	70	1.5
6016 03200	32	34	55	78	1.5
6016 04000	40	40	60	85	1.5
6016 05000	50	52	70	97	1.5

**1.4301 and 1.4404 are available.

D3WS Bend 180°, acc to DIN 11852

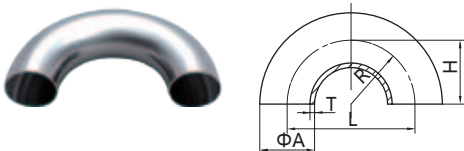

Basic Ordering Number: 6017

NO.	DN	A	L	R	H	T
6017 02000	20	23	80	40	40	1.5
6017 02500	25	29	100	50	50	1.5
6017 03200	32	35	110	55	55	1.5
6017 04000	40	41	120	60	60	1.5
6017 05000	50	53	140	70	70	1.5
6017 06500	65	70	160	80	80	2.0
6017 08000	80	85	180	90	90	2.0
6017 10000	100	104	200	100	100	2.0
6017 12500	125	129	375	187.5	187.5	2.0
6017 15000	150	154	450	225	225	2.0

**1.4301 and 1.4404 are available.

NOTE! Treatment: Annealed.

**All measurements are in millimeters (mm)
Conversion to inches, 25.4mm=1inch

DIN11852/DIN11850

Part for DIN tubes



Finish: OD: Semi bright. ID: Mirror
Connections: Welding ends

1.2

N3WS Bend 180°

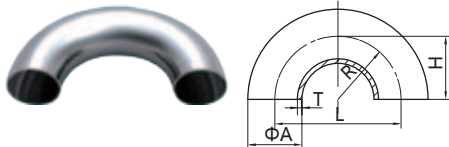

Basic Ordering Number: 6018

NO.	DN	A	L	R	H	T
6018 02000	20	22	80	40	40	1.5
6018 02500	25	28	100	50	50	1.5
6018 03200	32	34	110	55	55	1.5
6018 04000	40	40	120	60	60	1.5
6018 05000	50	52	140	70	70	1.5

**1.4301 and 1.4404 are available.

D7W Tee with straight-end, acc. to DIN 11852

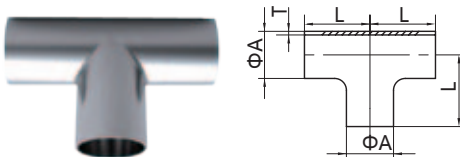

Basic Ordering Number: 6019

NO.	DN	A	L	T
6019 01000	10	13	26	1.5
6019 01500	15	19	35	1.5
6019 02000	20	23	40	1.5
6019 02500	25	29	50	1.5
6019 03200	32	35	55	1.5
6019 04000	40	41	60	1.5
6019 05000	50	53	70	1.5
6019 06500	65	70	80	2.0
6019 08000	80	85	90	2.0
6019 10000	100	104	100	2.0
6019 12500	125	129	187.5	2.0
6019 15000	150	154	225	2.0
6019 20000	200	204	300	2.0

**1.4301 and 1.4404 are available.

N7W Tee with straight-end

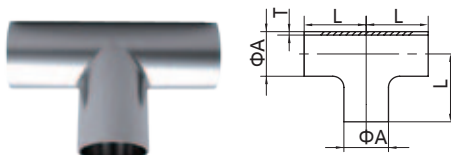

Basic Ordering Number: 6020

NO.	DN	A	L	T
6020 01000	10	12	26	1.5
6020 01500	15	18	35	1.5
6020 02000	20	22	40	1.5
6020 02500	25	28	50	1.5
6020 03200	32	34	55	1.5
6020 04000	40	40	60	1.5
6020 05000	50	52	70	1.5

**1.4301 and 1.4404 are available.

NOTE! Treatment: Annealed.

**All measurements are in millimeters (mm)
Conversion to inches, 25.4mm=1inch

DIN11852/DIN11850

Part for DIN tubes



TUBES AND FITTINGS **GEMO**

Finish: OD: Semi bright. ID: Mirror
Connections: Welding ends

1.2

DL7WWW Tee without straight-end, acc. to DIN 11852

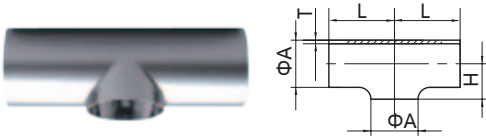

Basic Ordering Number: 6021

NO.	DN	A	L	H	T
6021 01000	10	13	26	9	1.5
6021 01500	15	19	35	11	1.5
6021 02000	20	23	40	13	1.5
6021 02500	25	29	50	16	1.5
6021 03200	32	35	55	19.5	1.5
6021 04000	40	41	60	23	1.5
6021 05000	50	53	70	30	1.5
6021 06500	65	70	80	40	2.0
6021 08000	80	85	90	47.5	2.0
6021 10000	100	104	100	58	2.0
6021 12500	125	129	187.5	74	2.0
6021 15000	150	154	225	90	2.0
6021 20000	200	204	300	115	2.0

**1.4301 and 1.4404 are available.

NL7WWW Tee without straight-end

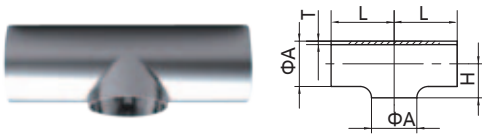

Basic Ordering Number: 6022

NO.	DN	A	L	H	T
6022 01000	10	12	26	9	1.5
6022 01500	15	18	35	11	1.5
6022 02000	20	22	40	13	1.5
6022 02500	25	28	50	16	1.5
6022 03200	32	34	55	19.5	1.5
6022 04000	40	40	60	23	1.5
6022 05000	50	52	70	30	1.5

**1.4301 and 1.4404 are available.

NOTE! Treatment: Annealed.

**All measurements are in millimeters (mm)
Conversion to inches, 25.4mm=1inch

DIN11852/DIN11850

Part for DIN tubes



Finish: OD: Semi bright. ID: Mirror
Connections: Welding ends

1.2

DL7W Reducing Tee with straight-end, acc. to DIN 11852

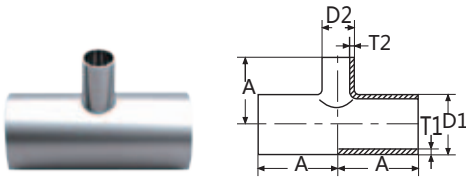

Basic Ordering Number: 6023

NO.	DN	D1×T1	D2×T2	A	kg
6023 02520	25/20	29×1.5	23×1.5	50	0.12
6023 03225	32/25	35×1.5	29×1.5	55	0.15
6023 04025	40/25	41×1.5	29×1.5	60	0.18
6023 04032	40/32	41×1.5	35×1.5	60	0.20
6023 05025	50/25	53×1.5	29×1.5	70	0.27
6023 05040	50/40	53×1.5	41×1.5	70	0.31
6023 06525	65/25	70×2.0	29×1.5	80	0.50
6023 06540	65/40	70×2.0	41×1.5	80	0.51
6023 06550	65/50	70×2.0	53×1.5	80	0.60
6023 08025	80/25	85×2.0	29×1.5	90	0.73
6023 08040	80/40	85×2.0	41×1.5	90	0.74
6023 08050	80/50	85×2.0	53×1.5	90	0.76
6023 08065	80/65	85×2.0	70×2.0	90	0.84
6023 10025	100/25	104×2.0	29×1.5	100	1.02
6023 10040	100/40	104×2.0	41×1.5	100	1.06
6023 10050	100/50	104×2.0	53×1.5	100	1.08
6023 10065	100/65	104×2.0	70×2.0	100	1.17
6023 10080	100/80	104×2.0	85×2.0	100	1.24
6023 12525	125/25	129×2.0	29×1.5	187.5	2.02
6023 12540	125/40	129×2.0	41×1.5	187.5	2.04
6023 12550	125/50	129×2.0	53×1.5	187.5	2.07
6023 12565	125/65	129×2.0	70×2.0	187.5	2.08
6023 12580	125/80	129×2.0	85×2.0	187.5	2.17
6023 125100	125/100	129×2.0	104×2.0	187.5	2.22
6023 15025	150/25	154×2.0	29×1.5	225	2.98
6023 15040	150/40	154×2.0	41×1.5	225	2.99
6023 15050	150/50	154×2.0	53×1.5	225	3.02
6023 15065	150/65	154×2.0	70×2.0	225	3.03
6023 15080	150/80	154×2.0	85×2.0	225	3.09
6023 150100	150/100	154×2.0	104×2.0	225	3.18
6023 150125	150/125	154×2.0	129×2.0	225	3.39

**1.4301 and 1.4404 are available.

NOTE! Treatment: Annealed.

**All measurements are in millimeters (mm)
Conversion to inches, 25.4mm=1inch

DIN11852/DIN11850

Part for DIN tubes



Finish: OD: Semi bright. ID: Mirror
Connections: Welding ends

NL7W Reducing Tee with straight-end

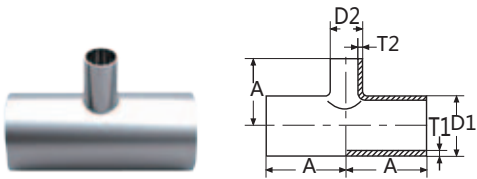

Basic Ordering Number: 6024

NO.	DN	D1×T1	D2×T2	A	kg
6024 02520	25/20	28×1.5	22×1.5	50	0.12
6024 03225	32/25	34×1.5	28×1.5	55	0.15
6024 04025	40/25	40×1.5	28×1.5	60	0.18
6024 04032	40/32	40×1.5	34×1.5	60	0.20
6024 05025	50/25	52×1.5	28×1.5	70	0.27
6024 05040	50/40	52×1.5	40×1.5	70	0.31
6024 06525	65/25	70×2.0	28×1.5	80	0.50
6024 06540	65/40	70×2.0	40×1.5	80	0.51
6024 06550	65/50	70×2.0	52×1.5	80	0.60
6024 08025	80/25	85×2.0	28×1.5	90	0.73
6024 08040	80/40	85×2.0	40×1.5	90	0.74
6024 08050	80/50	85×2.0	52×1.5	90	0.76
6024 10025	100/25	104×2.0	28×1.5	100	1.02
6024 10040	100/40	104×2.0	40×1.5	100	1.06
6024 10050	100/50	104×2.0	52×1.5	100	1.08
6024 12525	125/25	129×2.0	28×1.5	187.5	2.02
6024 12540	125/40	129×2.0	40×1.5	187.5	2.04
6024 12550	125/50	129×2.0	52×1.5	187.5	2.07
6024 15025	150/25	154×2.0	28×1.5	225	2.98
6024 15040	150/40	154×2.0	40×1.5	225	2.99
6024 15050	150/50	154×2.0	52×1.5	225	3.02

**1.4301 and 1.4404 are available.

NOTE! Treatment: Annealed.

**All measurements are in millimeters (mm)
Conversion to inches, 25.4mm=1inch

DIN11852/DIN11850

Part for DIN tubes



Finish: OD: Semi bright. ID: Mirror
Connections: Welding ends

1.2

D7W Reducing Tee without straight-end, acc. to DIN 11852

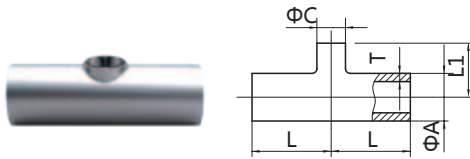

Basic Ordering Number: 6025

NO.	DN	A	C	L	L1	T
6025 02520	25-20	29	23	50	17	1.5
6025 03225	32-25	35	29	55	19.5	1.5
6025 04025	40-25	41	29	60	22.5	1.5
6025 04032	40-32	41	35	60	22.5	1.5
6025 05025	50-25	53	29	70	29.5	1.5
6025 05032	50-32	53	35	70	29.5	1.5
6025 05040	50-40	53	41	70	29.5	1.5
6025 06525	65-25	70	29	80	39	2.0
6025 06532	65-32	70	35	80	39	2.0
6025 06540	65-40	70	41	80	39	2.0
6025 06550	65-50	70	53	80	39	2.0
6025 08025	80-25	85	29	90	46.5	2.0
6025 08032	80-32	85	35	90	46.5	2.0
6025 08040	80-40	85	41	90	46.5	2.0
6025 08050	80-50	85	53	90	46.5	2.0
6025 08065	80-65	85	70	90	46.5	2.0
6025 10025	100-25	104	29	100	56	2.0
6025 10032	100-32	104	35	100	56	2.0
6025 10040	100-40	104	41	100	56	2.0
6025 10050	100-50	104	53	100	56	2.0
6025 10065	100-65	104	70	100	56	2.0
6025 10080	100-80	104	85	100	56	2.0
6025 12525	125-25	129	29	187.5	68.5	2.0
6025 12532	125-32	129	35	187.5	68.5	2.0
6025 12540	125-40	129	41	187.5	68.5	2.0
6025 12550	125-50	129	53	187.5	68.5	2.0
6025 12565	125-65	129	70	187.5	68.5	2.0
6025 12580	125-80	129	85	187.5	68.5	2.0
6025 125100	125-100	129	104	187.5	68.5	2.0
6025 15032	150-32	154	35	225	81	2.0
6025 15040	150-40	154	41	225	81	2.0
6025 15050	150-50	154	53	225	81	2.0
6025 15065	150-65	154	70	225	81	2.0
6025 15080	150-80	154	85	225	81	2.0
6025 150100	150-100	154	104	225	81	2.0
6025 150125	150-125	154	129	225	81	2.0

**1.4301 and 1.4404 are available.

NOTE! Treatment: Annealed.

**All measurements are in millimeters (mm)
Conversion to inches, 25.4mm=1inch

DIN11852/DIN11850

Part for DIN tubes



TUBES AND FITTINGS **GEMO**

Finish: OD: Semi bright. ID: Mirror
Connections: Welding ends

1.2

N7W Reducing Tee without straight-end

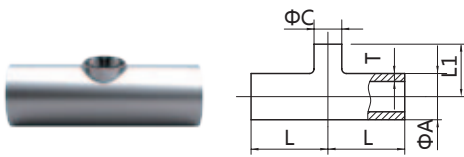

Basic Ordering Number: 6026

NO.	DN	A	C	L	L1	T
6026 02520	25-20	28	22	50	17	1.5
6026 03225	32-25	34	28	55	19.5	1.5
6026 04025	40-25	40	28	60	22.5	1.5
6026 04032	40-32	40	34	60	22.5	1.5
6026 05025	50-25	52	28	70	29.5	1.5
6026 05032	50-32	52	34	70	29.5	1.5
6026 05040	50-40	52	40	70	29.5	1.5
6026 06525	65-25	70	28	80	39	2.0
6026 06532	65-32	70	34	80	39	2.0
6026 06540	65-40	70	40	80	39	2.0
6026 06550	65-50	70	52	80	39	2.0
6026 08025	80-25	85	28	90	46.5	2.0
6026 08032	80-32	85	34	90	46.5	2.0
6026 08040	80-40	85	40	90	46.5	2.0
6026 08050	80-50	85	52	90	46.5	2.0
6026 10025	100-25	104	28	100	56	2.0
6026 10032	100-32	104	34	100	56	2.0
6026 10040	100-40	104	40	100	56	2.0
6026 10050	100-50	104	52	100	56	2.0

**1.4301 and 1.4404 are available.

NOTE! Treatment: Annealed.

**All measurements are in millimeters (mm)
Conversion to inches, 25.4mm=1inch

DIN11852/DIN11850

Part for DIN tubes



Finish: OD: Semi bright. ID: Mirror
Connections: Welding ends

1.2

DL31 Concentric Reducer

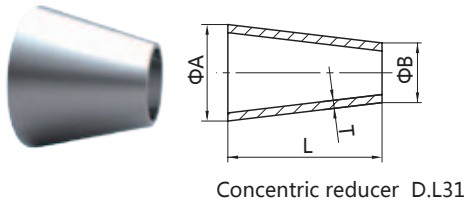

Basic Ordering Number: 6027

NO.	DN	A	B	L	T
6027 01510	15×10	18	12	11	1.5
6027 02010	20×10	22	12	18	1.5
6027 02015	20×15	22	18	7	1.5
6027 02510	25×10	28	12	28	1.5
6027 02515	25×15	28	18	18	1.5
6027 02520	25×20	28	22	23	1.5
6027 03215	32×15	34	18	30	1.5
6027 03220	32×20	34	22	22	1.5
6027 03225	32×25	34	28	11	1.5
6027 04020	40×20	40	22	33	1.5
6027 04025	40×25	40	28	22	1.5
6027 04032	40×32	40	34	11	1.5
6027 05025	50×25	52	28	44	1.5
6027 05032	50×32	52	34	33	1.5
6027 05040	50×40	52	40	22	1.5
6027 06532	65×32	70	34	62	2.0
6027 06540	65×40	70	40	51	2.0
6027 06550	65×50	70	52	29	2.0
6027 08040	80×40	85	40	78	2.0
6027 08050	80×50	85	52	56	2.0
6027 08065	80×65	85	70	27	2.0
6027 10050	100×50	104	52	90	2.0
6027 10065	100×65	104	70	64	2.0
6027 10080	100×80	104	85	34	2.0
6027 12565	125×65	129	70	96	2.0
6027 12580	125×80	129	85	79	2.0
6027 125100	125×100	129	104	45	2.0
6027 15080	150×80	154	85	90	2.0
6027 150100	150×100	154	104	66.5	2.0
6027 150125	150×125	154	129	45	2.0
6027 200150	200×150	204	154	68	2.0

**1.4301 and 1.4404 are available.

NOTE! Treatment: Annealed.

**All measurements are in millimeters (mm)
Conversion to inches, 25.4mm=1inch

DIN11852/DIN11850

Part for DIN tubes



TUBES AND FITTINGS **GEMO**

Finish: OD: Semi bright. ID: Mirror
Connections: Welding ends

1.2

DL32 Eccentric Reducer

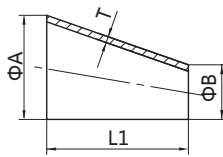

Eccentric reducer D.L32

Basic Ordering Number: 6028

NO.	DN	A	B	L1	T
6028 01510	15×10	18	12	16.5	1.5
6028 02010	20×10	22	12	27.5	1.5
6028 02015	20×15	22	18	11	1.5
6028 02510	25×10	28	12	44	1.5
6028 02515	25×15	28	18	27.5	1.5
6028 02520	25×20	28	22	16.5	1.5
6028 03215	32×15	34	18	44	1.5
6028 03220	32×20	34	22	33	1.5
6028 03225	32×25	34	28	14.5	1.5
6028 04020	40×20	40	22	49.5	1.5
6028 04025	40×25	40	28	33	1.5
6028 04032	40×32	40	34	16.5	1.5
6028 05025	50×25	52	28	66	1.5
6028 05032	50×32	52	34	49.5	1.5
6028 05040	50×40	52	40	33	1.5
6028 06532	65×32	70	34	92	2.0
6028 06540	65×40	70	40	77	2.0
6028 06550	65×50	70	52	44	2.0
6028 08040	80×40	85	40	97	2.0
6028 08050	80×50	85	52	85	2.0
6028 08065	80×65	85	70	41.2	2.0
6028 10050	100×50	104	52	137.5	2.0
6028 10065	100×65	104	70	93.5	2.0
6028 10080	100×80	104	85	52.5	2.0
6028 12565	125×65	129	70	138	2.0
6028 12580	125×80	129	85	121	2.0
6028 125100	125×100	129	104	68.5	2.0
6028 15080	150×80	154	85	110	2.0
6028 150100	150×100	154	104	90	2.0
6028 150125	150×125	154	129	68.5	2.0

**1.4301 and 1.4404 are available.

NOTE! Treatment: Annealed.

**All measurements are in millimeters (mm)
Conversion to inches, 25.4mm=1inch

1.2

CLAMP UNION DIN32676

Clamp ferrule, acc. To DIN 32676

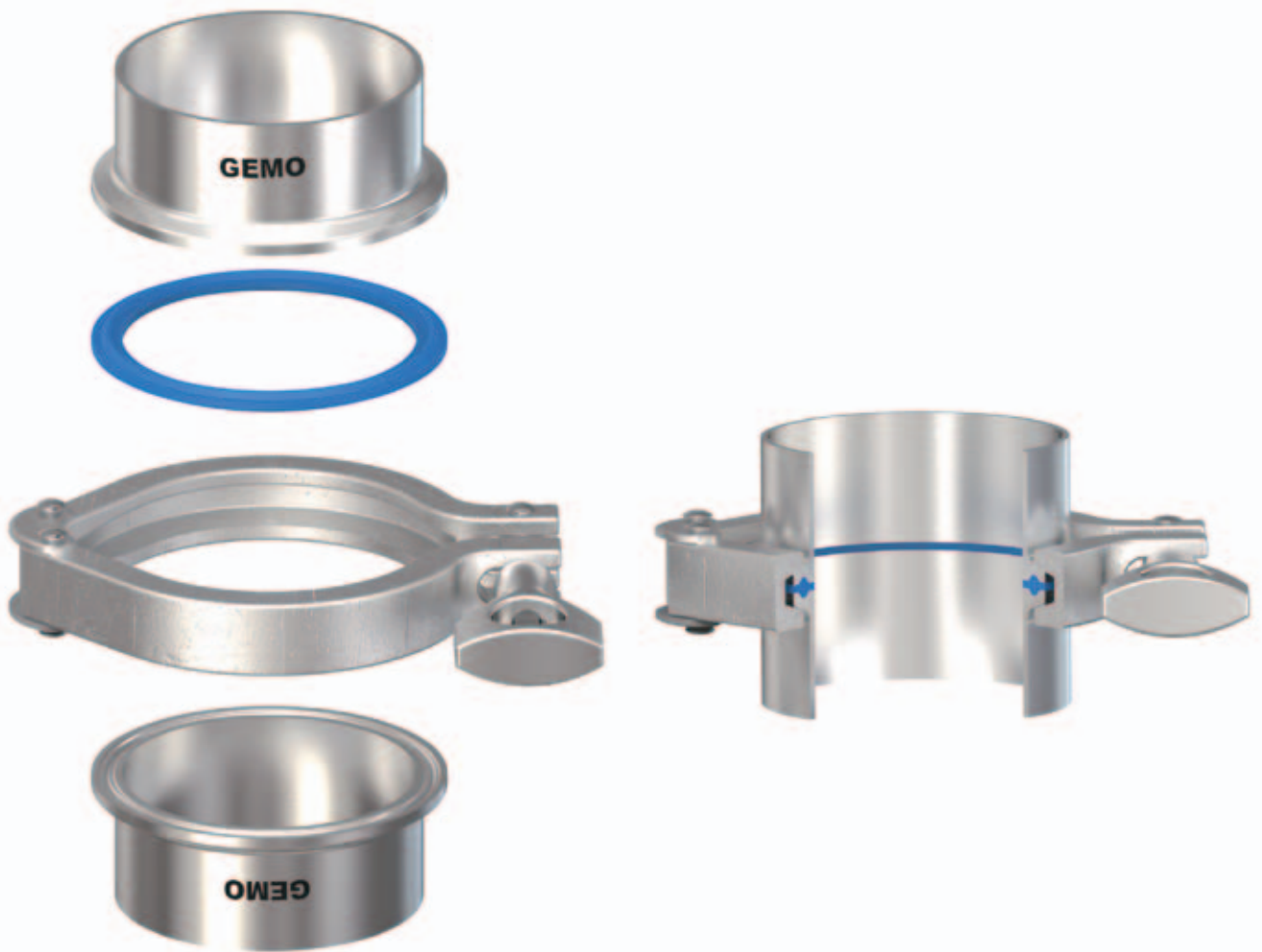

A13MHM Single heavy duty clamp in page 16 can apply to DIN32676.

EACH FITTINGS PACKAGING HAS A BARCODE

CLAMP UNIONS DIN32676

Part for DIN tubes

Finish: OD: Semi bright. ID: Semi bright
Connections: Welding ends



D14AM Ferrule

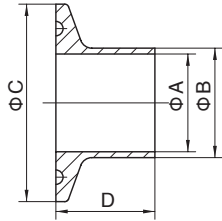

Basic Ordering Number: 6029

NO.	DN	A	B	C	D
6029 01000	10	10	13	34	18
6029 01500	15	16	19	34	18
6029 02000	20	20	23	34	18
6029 02500	25	26	29	50.5	21.5
6029 03200	32	32	35	50.5	21.5
6029 04000	40	38	41	50.5	21.5
6029 05000	50	50	53	64	21.5
6029 06500	65	66	70	91	28
6029 08000	80	81	85	106	28
6029 10000	100	100	104	119	28
6029 12500	125	125	129	155	28
6029 15000	150	150	154	183	28
6029 20000	200	200	204	233.5	28

**1.4301 and 1.4404 are available.

N14AM Ferrule

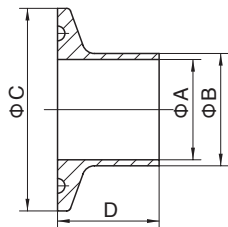

Basic Ordering Number: 6030

NO.	DN	A	B	C	D
6030 01000	10	9	12	34	18
6030 01500	15	15	18	34	18
6030 02000	20	19	22	34	18
6030 02500	25	25	28	50.5	21.5
6030 03200	32	31	34	50.5	21.5
6030 04000	40	37	40	50.5	21.5
6030 05000	50	49	52	64	21.5

**1.4301 and 1.4404 are available.

40MP Gasket

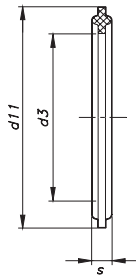

Basic Ordering Number: 6031

NO.	DN	d3	d11	S
6031 01000	10	10.2	34	5.5
6031 01500	15	16.2	34	5.5
6031 02000	20	20.2	34	5.5
6031 02500	25	26.2	50.5	5.5
6031 03200	32	32.2	50.5	5.5
6031 04000	40	38.2	50.5	5.5
6031 05000	50	50.2	64	5.5
6031 06500	65	66.2	91	5.5
6031 08000	80	81.2	106	5.5
6031 10000	100	100.2	119	5.5

**Silicone, EPDM, FPM and PTFE are available.

NOTE!

**All measurements are in millimeters (mm)
Conversion to inches, 25.4mm=1inch

CLAMP UNIONS DIN32676

Part for DIN tubes

Finish: OD: Semi bright. ID: Semi bright
Connections: Welding ends



1.2

16AMP Solid End Cap

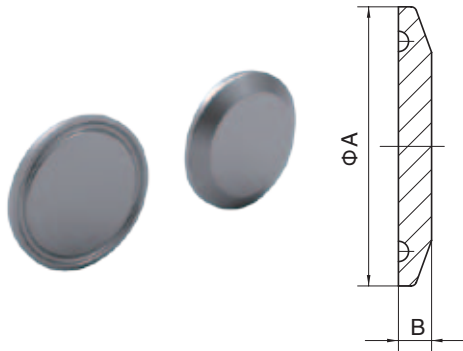

Basic Ordering Number: 6032

NO.	DN	A	B
6032 01020	10-20	34	6.4
6032 02540	25-40	50.5	6.4
6032 05000	50	64.0	6.4
6032 06500	65	91.0	6.4
6032 08000	80	106.0	7.9
6032 10000	100	119.0	7.9
6032 12500	125	155.0	11.1
6032 15000	150	183.0	11.1
6032 20000	200	233.5	11.1

**1.4301 and 1.4404 are available.

13MHHM Double Hinge Heavy Duty Clamp

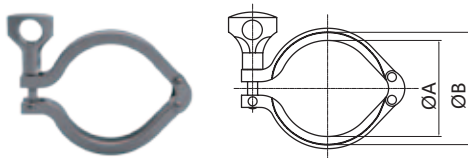

Basic Ordering Number: 6033

NO.	DN	A	B
6033 02540	25-40	44.4	53.6
6033 05000	50	57.8	67
6033 06500	65	84	94.2
6033 08000	80	99	109.2
6033 10000	100	110	122.2
6033 12500	125	144	159
6033 15000	150	172	187
6033 20000	200	222.5	237.5

**Only 1.4301 is available.

NOTE!

**All measurements are in millimeters (mm)
Conversion to inches, 25.4mm=1inch

UNIONS

DIN11851/DIN11850

1.2



DIN11851 Unions All acc. To GERMANY DIN Standard
EACH FITTINGS PACKAGING HAS A BARCODE

1.2 UNIONS DIN11851/DIN11850

The DIN union is the German standard hygienic fitting, A complete range of DIN fittings are offered in order to meet the needs of imported equipment from Europe. These fittings are used for hygienic purposes and offer a leak-free joint obtained with a rubber seal. Available in sizes

DN15mm to DN150mm.



GEMO DIN Unions meet

DIN requirements

DIN11851/DIN11850

FITTINGS SPECIFICATIONS....

Size Range: DN10 ID through DN150 ID
 Materials: 1.4301(304), 1.4404(316L)
 Processing: Forging
 Machined by CNC
 Internal 21Ra(0.51µm) External 32Ra(0.8µm)
 Working Pressure Range, (Fully Forged Unions):
 DN 10 - DN 40 Max, Working Pressure 40 Bar @ 20°C
 DN 50 - DN 100 Max, Working pressure 25 Bar @ 20°C
 DN 125 - DN 150 Max, Working pressure 16 Bar @ 20°C

ORDERING SPECIFICATIONS....

- Specify:
- Description
 - Code No.
 - Size
 - Material
 - Surface Polish Requirements
 - Quantity

Description	Item No	Size	Material	Surface	Quantity
DIN-13	6034	DN50	1.4301	Ra≤0.8µm	500

NOTES THE DIMENSION TABLES

- All Dimensions are according to DIN standard.
- Wall Thickness: Fittings DN15-DN50 sizes are manufactured with 1.5 mm wall thickness. The DN65-DN200 tube size is manufactured with 2mm wall thickness.

NOTE! Treatment: CNC Finished

**All measurements are in millimeters (mm)
 Conversion to inches, 25.4mm=1inch

UNIONS DIN11851/DIN11850

Part for DIN tubes



Finish: OD: Semi bright. ID: Semi bright
 Connections: Welding ends
 Seals: Silicone
 Thread: Round type 

1.2

DIN-13 Nut

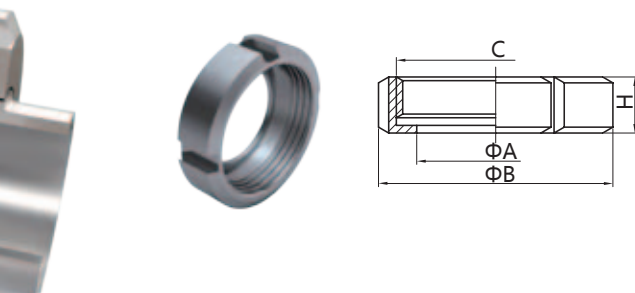

Basic Ordering Number: 6034

NO.	DN	A	B	C	H
6034 01000	10	19	38	Rd28×1/8"	18
6034 01500	15	25	44	Rd34×1/8"	18
6034 02000	20	31	54	Rd44×1/6"	20
6034 02500	25	36	63	Rd52×1/6"	21
6034 03200	32	42.5	70	Rd58×1/6"	21
6034 04000	40	49	78	Rd65×1/6"	21
6034 05000	50	62	92	Rd78×1/6"	22
6034 06500	65	80	112	Rd95×1/6"	25
6034 07530	75-3.0	86.5	120	Rd104×1/6"	26
6034 08000	80	94	127	Rd110×1/4"	29
6034 10000	100	115	138	Rd130×1/4"	31
6034 12500	125	138	178	Rd160×1/4"	35
6034 15000	150	164	210	Rd190×1/4"	40

DIN-14 Welding liner

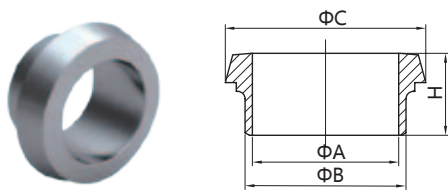

Basic Ordering Number: 6035

**Only 1.4301 is available.

NO.	DN	A	B	C	H
6035 01000	10	10	15	22.5	17
6035 01500	15	16	21	28.5	17
6035 02000	20	20	25	36.5	18
6035 02500	25	26	31	44	22
6035 03200	32	32	37	50	25
6035 04000	40	38	43	56	26
6035 05000	50	50	55	68.5	28
6035 06500	65	66	72	86	32
6035 08000	80	81	87	100	37
6035 10000	100	100	106	121	44
6035 12500	125	125	132	150	34
6035 15000	150	150	157	176	37

DIN-15 Welding male

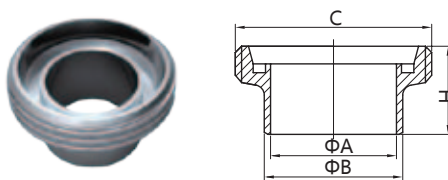

Basic Ordering Number: 6036

**1.4301 and 1.4404 are available.

NO.	DN	A	B	C	H
6036 01000	10	10	15	Rd28×1/8"	21
6036 01500	15	16	21	Rd34×1/8"	21
6036 02000	20	20	25	Rd44×1/6"	24
6036 02500	25	26	31	Rd52×1/6"	29
6036 03200	32	32	37	Rd58×1/6"	32
6036 04000	40	38	43	Rd65×1/6"	33
6036 05000	50	50	55	Rd78×1/6"	35
6036 06500	65	66	72	Rd95×1/6"	40
6036 08000	80	81	87	Rd110×1/4"	45
6036 10000	100	100	106	Rd130×1/4"	54
6036 12500	125	125	132	Rd160×1/4"	46
6036 15000	150	150	157	Rd190×1/4"	50

**1.4301 and 1.4404 are available.

NOTE! Treatment: CNC Finished

**All measurements are in millimeters (mm)
 Conversion to inches, 25.4mm=1inch

UNIONS DIN11851/DIN11850

Part for DIN tubes



Finish: OD: Semi bright. ID: Semi bright
 Connections: Welding ends
 Seals: Silicone
 Thread: Round type 

1.2

DIN-16 Silicone Seal

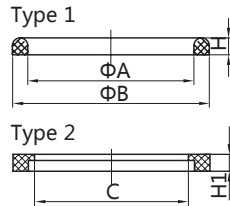

Basic Ordering Number: 6037

NO.	DN	A	B	C	H	H1
6037 01000	10	12	20	10.2	4.5	5
6037 01500	15	18	26	16.2	4.5	5
6037 02000	20	23	33	20.2	4.5	5
6037 02500	25	30	40	26.2	5	6
6037 03200	32	36	46	32.2	5	6
6037 04000	40	42	52	38.2	5	6
6037 05000	50	54	64	50.2	5	6
6037 06500	65	71	81	66.2	5	6
6037 08000	80	85	95	81.2	5	6
6037 10000	100	104	114	100.2	6	6
6037 12500	125	130	142	125.2	7	7
6037 15000	150	155	167	150.2	7	7

**Silicone and EPDM are available.

DIN-14H Welding liner

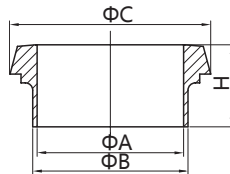

Basic Ordering Number: 6038

NO.	DN	A	B	C	H
6038 01000	10	10	13	22.5	17
6038 01500	15	16	19	28.5	17
6038 02000	20	20	23	36.5	18
6038 02500	25	26	29	44	22
6038 03200	32	32	35	50	25
6038 04000	40	38	41	56	26
6038 05000	50	50	53	68.5	28
6038 06500	65	66	70	86	32
6038 08000	80	81	85	100	37
6038 10000	100	100	104	121	44
6038 12500	125	125	129	150	34
6038 15000	150	150	154	176	37

**1.4301 and 1.4404 are available.

DIN-15H Welding male

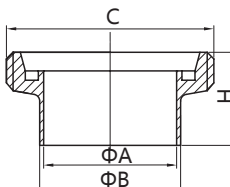

Basic Ordering Number: 6039

NO.	DN	A	B	C	H
6039 01000	10	10	13	Rd28×1/8"	21
6039 01500	15	16	19	Rd34×1/8"	21
6039 02000	20	20	23	Rd44×1/6"	24
6039 02500	25	26	29	Rd52×1/6"	29
6039 03200	32	32	35	Rd58×1/6"	32
6039 04000	40	38	41	Rd65×1/6"	33
6039 05000	50	50	53	Rd78×1/6"	35
6039 06500	65	66	70	Rd95×1/6"	40
6039 08000	80	81	85	Rd110×1/4"	45
6039 10000	100	100	104	Rd130×1/4"	54
6039 12500	125	125	129	Rd160×1/4"	46
6039 15000	150	150	154	Rd190×1/4"	50

**1.4301 and 1.4404 are available.

NOTE! Treatment: CNC Finished

**All measurements are in millimeters (mm)
 Conversion to inches, 25.4mm=1inch

UNIONS DIN11851/DIN11850

Part for DIN tubes



Finish: OD: Semi bright. ID: Semi bright
 Connections: Welding ends
 Seals: Silicone
 Thread: Round type

DIN-14S Welding liner

Basic Ordering Number: 6040

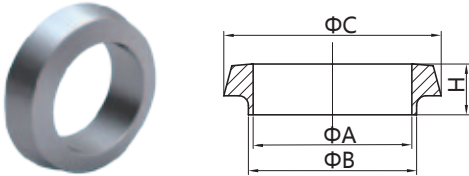

NO.	DN	A	B	C	H
6040 01000	10	10	13	22.5	13
6040 01500	15	16	19	28.5	13
6040 02000	20	20	23	36.5	13
6040 02500	25	26	29	44	15
6040 03200	32	32	35	50	15
6040 04000	40	38	41	56	15
6040 05000	50	50	53	68.5	16
6040 06500	65	66	70	86	17
6040 08000	80	81	85	100	17
6040 10000	100	100	104	121	20
6040 12500	125	125	129	150	23.5
6040 15000	150	150	154	176	27

**1.4301 and 1.4404 are available.

DIN-15S Welding male

Basic Ordering Number: 6041

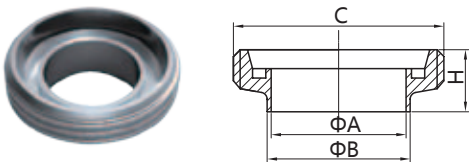

NO.	DN	A	B	C	H
6041 01000	10	10	13	Rd28×1/8"	17
6041 01500	15	16	19	Rd34×1/8"	17
6041 02000	20	20	23	Rd44×1/6"	19
6041 02500	25	26	29	Rd52×1/6"	22
6041 03200	32	32	35	Rd58×1/6"	22
6041 04000	40	38	41	Rd65×1/6"	22
6041 05000	50	50	53	Rd78×1/6"	23
6041 06500	65	66	70	Rd95×1/6"	25
6041 08000	80	81	85	Rd110×1/4"	25
6041 10000	100	100	104	Rd130×1/4"	30
6041 12500	125	125	129	Rd160×1/4"	35.5
6041 15000	150	150	154	Rd190×1/4"	40

**1.4301 and 1.4404 are available.

DIN-14P Welding liner

Basic Ordering Number: 6042

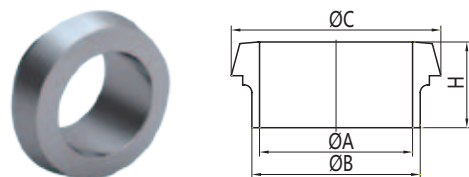

NO.	DN	A	B	C	H
6042 01000	10	9	12	22.5	17
6042 01500	15	15	18	28.5	17
6042 02000	20	19	22	36.5	18
6042 02500	25	25	28	44	22
6042 03200	32	31	34	50	25
6042 04000	40	37	40	56	26
6042 05000	50	49	52	68.5	28

**1.4301 and 1.4404 are available.

NOTE! Treatment: CNC Finished

**All measurements are in millimeters (mm)
 Conversion to inches, 25.4mm=1inch

UNIONS DIN11851/DIN11850

Part for DIN tubes



Finish: OD: Semi bright. ID: Semi bright
 Connections: Welding ends
 Seals: Silicone
 Thread: Round type 

1.2

DIN-15P Reducing Welding male

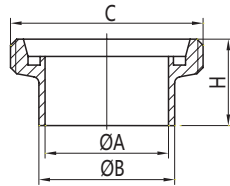

Basic Ordering Number: 6043

NO.	DN	A	B	C	H
6043 01000	10	9	12	RD28×1/8"	21
6043 01500	15	15	18	RD34×1/8"	21
6043 02000	20	19	22	RD44×1/6"	24
6043 02500	25	25	28	RD52×1/6"	29
6043 03200	32	31	34	RD58×1/6"	32
6043 04000	40	37	40	RD65×1/6"	33
6043 05000	50	49	52	RD78×1/6"	35

**1.4301 and 1.4404 are available.

DIN-14T Thickening liner

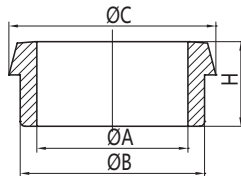

Basic Ordering Number: 6044

NO.	DN	A	B	C	H
6044 01000	10	10	18	22.5	17
6044 01500	15	16	24	28.5	17
6044 02000	20	20	30	36.5	18
6044 02500	25	26	35	44	22
6044 03200	32	32	41	50	25
6044 04000	40	38	48	56	26
6044 05000	50	50	61	68.5	28
6044 06500	65	66	79	86	32
6044 08000	80	81	93	100	37
6044 10000	100	100	114	121	44

**1.4301 and 1.4404 are available.

DIN-15T Thickening Welding male

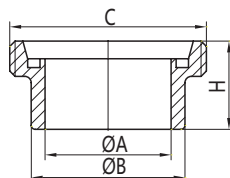

Basic Ordering Number: 6045

NO.	DN	A	B	C	H
6045 01000	10	10	18	RD28×1/8"	21
6045 01500	15	16	24	RD34×1/8"	21
6045 02000	20	20	30	RD44×1/6"	24
6045 02500	25	26	35	RD52×1/6"	29
6045 03200	32	32	41	RD58×1/6"	32
6045 04000	40	38	48	RD65×1/6"	33
6045 05000	50	50	61	RD78×1/6"	35
6045 06500	65	66	79	RD95×1/6"	40
6045 08000	80	81	93	RD110×1/4"	45
6045 10000	100	100	114	RD130×1/4"	54

**1.4301 and 1.4404 are available.

NOTE! Treatment: CNC Finished

**All measurements are in millimeters (mm)
 Conversion to inches, 25.4mm=1inch

UNIONS DIN11851/DIN11850

Part for DIN tubes



Finish: OD: Semi bright. ID: Semi bright
 Connections: Welding ends
 Seals: Silicone
 Thread: Round type

DIN-14B Blind liner

Basic Ordering Number: 6046

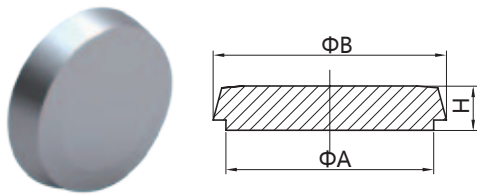

NO.	DN	A	B	H
6046 01000	10	18	22.5	9
6046 01500	15	24	28.5	9
6046 02000	20	30	36.5	11
6046 02500	25	35	44	13
6046 03200	32	41	50	13
6046 04000	40	48	56	13
6046 05000	50	61	68.5	14
6046 06500	65	79	86	16
6046 08000	80	93	100	16
6046 10000	100	114	121	20
6046 12500	125	137	150	22
6046 15000	150	163	176	24

**1.4301 and 1.4404 are available.

DIN-13RS Nut

Basic Ordering Number: 6047

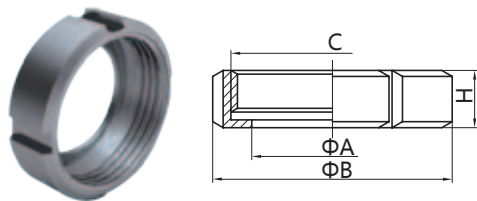

NO.	DN	A	B	C	H
6047 01000	10	19	36	Rd28x1/8"	18
6047 01500	15	25	42	Rd34x1/8"	18
6047 02000	20	31	52	Rd44x1/6"	20
6047 02500	25	36	61	Rd52x1/6"	21
6047 03200	32	42.5	68	Rd58x1/6"	21
6047 04000	40	49	76	Rd65x1/6"	21
6047 05000	50	62	90	Rd78x1/6"	22
6047 06500	65	80	108	Rd95x1/6"	25
6047 08000	80	94	125	Rd110x1/4"	29
6047 10000	100	115	145	Rd130x1/4"	30

**Only 1.4301 is available.

DIN-13RB Blind Nut

Basic Ordering Number: 6048

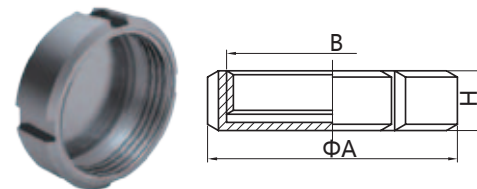

NO.	DN	A	B	H
6048 01000	10	38	Rd28x1/8"	18
6048 01500	15	44	Rd34x1/8"	18
6048 02000	20	54	Rd44x1/6"	20
6048 02500	25	63	Rd52x1/6"	21
6048 03200	32	70	Rd58x1/6"	21
6048 04000	40	78	Rd65x1/6"	21
6048 05000	50	92	Rd78x1/6"	22
6048 06500	65	112	Rd95x1/6"	25
6048 08000	80	127	Rd110x1/4"	29
6048 10000	100	148	Rd130x1/4"	31
6048 12500	125	178	Rd160x1/4"	35
6048 15000	150	210	Rd190x1/4"	40

**Only 1.4301 is available.

NOTE! Treatment: CNC Finished

**All measurements are in millimeters (mm)
 Conversion to inches, 25.4mm=1inch

UNIONS DIN11851/DIN11850

Part for DIN tubes



Finish: OD: Semi bright. ID: Semi bright
 Connections: Welding ends
 Seals: Silicone
 Thread: Round type 

1.2

DIN-13RBN Blind Nut with boss

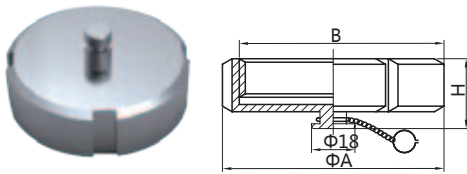

Basic Ordering Number: 6049

NO.	DN	A	B	H
6049 01000	10	38	Rd28×1/8"	25
6049 01500	15	44	Rd34×1/8"	25
6049 02000	20	54	Rd44×1/6"	27
6049 02500	25	63	Rd52×1/6"	28
6049 03200	32	70	Rd58×1/6"	28
6049 04000	40	78	Rd65×1/6"	28
6049 05000	50	92	Rd78×1/6"	29
6049 06500	65	112	Rd95×1/6"	32
6049 08000	80	127	Rd110×1/4"	36
6049 10000	100	148	Rd130×1/4"	38
6049 12500	125	178	Rd160×1/4"	42
6049 15000	150	210	Rd190×1/4"	47

**Only 1.4301 is available.

P-16 Blind nut seal

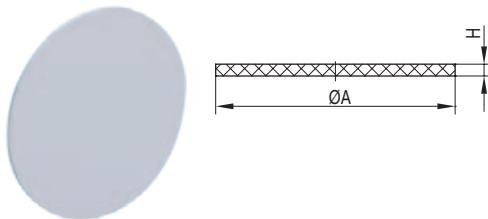

Basic Ordering Number: 6050

NO.	DN	A	H	H(PTFE)
6050 01000	10	28	3	1.5
6050 01500	15	34	3	1.5
6050 02000	20	44	3	1.5
6050 02500	25	52	3	1.5
6050 03200	32	58	3	1.5
6050 04000	40	65	3	1.5
6050 05000	50	78	3	1.5
6050 06500	65	95	3	1.5
6050 08000	80	110	3	1.5
6050 10000	100	130	3	1.5
6050 12500	125	160	3	1.5
6050 15000	150	190	3	1.5

**Silicone and EPDM are available.

NOTE! Treatment: CNC Finished

**All measurements are in millimeters (mm)
 Conversion to inches, 25.4mm=1inch

P&E Flow Technology Profile

P&E Flow Technology is provider of professional products for the fluid industry and related solutions.

We are committed to brew processing, beverage processing, Dairy and Foodstuff processing, pharmaceutical industry, water treatment works, Bio-engineering and fluid technology industry

P&E Flow Technology Brands

CKAN

ZIMANI

GEMO

Meatier

Shst

How to contact P&E Flow Technology
www.pestainless.com

GEMO Products Services
Please visit and contact us:
www.gemoindustries.com

Technical Support
Tech@gemoindustries.com

Service
Info@gemoindustries.com

Dealer Management
DealerManagement@gemoindustries.com

P&E Flow Technology

Address: Shacheng Street, WenZhou, P.R China.
Post Code: 325000

Service, Sales
Tel: +86-577-85826961
Email: Info@pestainless.com

Dealer Management
Email: DealerManagement@pestainless.com

Copyright © 2011 P&E

GEMO is a trademark registered and owned by P&E Flow Technology. P&E reserves the right to change specifications without prior notify action.