



1.1 SANITARY ASME

Catalog

Table of Contents page 11 – 24



S-Line Fittings

Introduction & Order Information

Elbows

5009 A2CMP.....	13
5010 A2KMP.....	13

Tees

5011 A7MP.....	13
5012 A7RMP.....	14

Crosses

5013 A9MP.....	14
----------------	----

Reducers

5014 A31-14MP.....	14
5015 A32-14MP.....	15

Ferrules

5016 L14AM.....	15
5017 14WMP.....	15

Clamps

5018 13MHHM	16
5019 A13MHM.....	16
5020 13MHHS / A13MHHS.....	17
5021 13MHHS 3-Segment.....	17
5022 13MHP.....	17

Gaskets

5023 40MP	18
-----------------	----

Solid End Caps

5024 16AMP	18
------------------	----

Weld Fittings

Introduction & Order Information

Bends

5025 A2WK	21
5026 AL2WS	21
5027 A2WCL	22
5028 AL2S.....	22

Tees

5029 AL7WWW.....	22
5030 A7W.....	22
5031 AL7RW.....	23

Crosses

5032 A9WWWWW.....	23
-------------------	----

Reducers

5033 L31.....	23
5034 L32.....	24

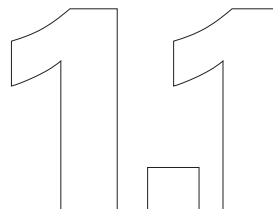

S-Line Fittings

S-LINE FITTINGS all acc. to 3A

1.1



Selection of the seals, please refer to the characteristics of the seals material.

EACH FITTINGS PACKAGING HAS A BARCODE

S-Line Fittings

1.1

The easiness that S-line fittings present as far as assembly and dismantling of process lines and equipment are concerned can not be matched.

Gaskets for S-line Fittings are available in several different materials, EPDM, Silicone, FPM, and PTFE.

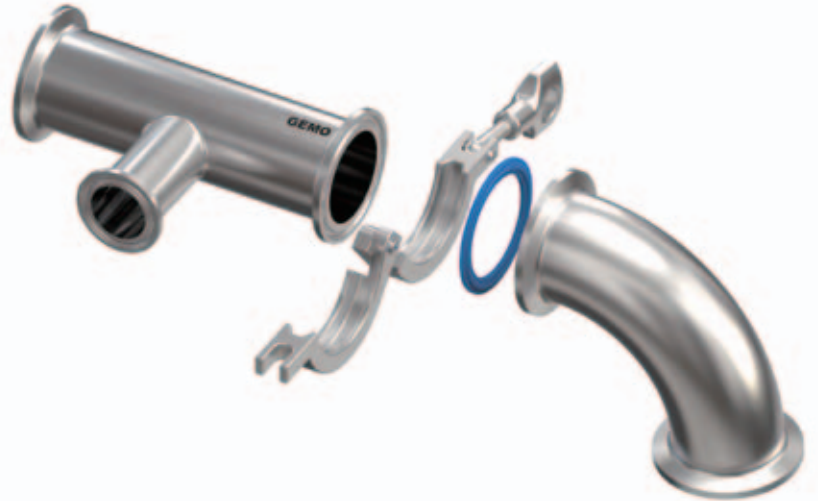

GEMO S-line Fittings meet



requirements.

S-LINE FITTINGS

SPECIFICATIONS....

Size Range: 1/2"OD through 12" OD
 Materials: T304, T316L
 Surface Finish:
 Mechanically Polished
 Internal 20Ra (0.51µm), External 32Ra (0.8µm)
 No. 7 - ID & OD
 No. 5 - OD only
 No. 3 - ID only
 No. 1 - unpolished
 Custom - built upon request

Example

Description	Code No	Size	Material	Surface	Quantity
A2CMP 90°	5009	2"	T316L	NO.7	500

ORDERING

SPECIFICATIONS....

Specify:

- Description
- Code No.
- Size
- Material
- Surface Polish Requirements
- Quantity

NOTES THE DIMENSION TABLES

- All Dimensions are in mm.
- Wall Thickness: Fittings 1.0"-3.0" sizes are manufactured with 16 gauge (0.065") wall thickness. The 4.0" tube size is manufactured with 14 gauge (0.083") wall thickness.

S-Line fittings

Part for ASTM A270 tubes

Finish: OD: Semi bright. ID: Mirror
Connections: Clamp ends



A2CMP 90° Elbow

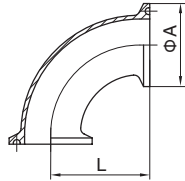

Basic Ordering Number: 5009

NO.	Size	A	L
5009 0100	1.0"	50.5	50.8
5009 0150	1.5"	50.5	69.9
5009 0200	2.0"	64.0	88.9
5009 0250	2.5"	77.5	107.95
5009 0300	3.0"	91.0	127.0
5009 0400	4.0"	119.0	168.2

**T304 and T316L are available.

A2KMP 45° Elbow

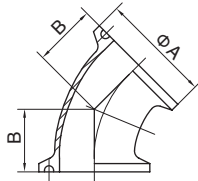

Basic Ordering Number: 5010

NO.	Size	A	B
5010 0100	1.0"	50.5	28.5
5010 0150	1.5"	50.5	36.5
5010 0200	2.0"	64.0	44.45
5010 0250	2.5"	77.5	52.3
5010 0300	3.0"	91.0	60.3
5010 0400	4.0"	119.0	76.2

**T304 and T316L are available.

A7MP Equal Tee

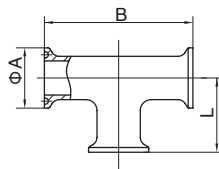

Basic Ordering Number: 5011

NO.	Size	A	B	L
5011 0100	1.0"	50.5	120.6	60.3
5011 0150	1.5"	50.5	139.8	69.9
5011 0200	2.0"	64.0	177.8	88.9
5011 0250	2.5"	77.5	177.8	88.9
5011 0300	3.0"	91.0	190.6	95.3
5011 0400	4.0"	119.0	228.4	114.2

**T304 and T316L are available.

NOTE! Treatment: Annealed.

**All measurements are in millimeters (mm)
Conversion to inches, 25.4mm=1inch

S-Line fittings

Part for ASTM A270 tubes

Finish: OD: Semi bright. ID: Mirror
Connections: Clamp ends



1.1

A7RMP Reducing Tee

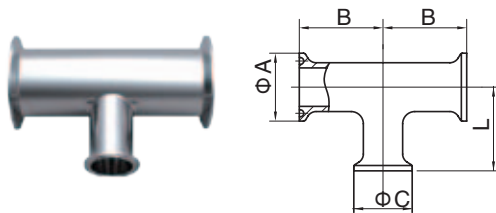

Basic Ordering Number: 5012

NO.	Size	A	C	B	L
5012 01510	1.5"×1.0"	50.5	50.5	69.85	66.68
5012 02010	2.0"×1.0"	64.0	50.5	88.90	73.0
5012 02015	2.0"×1.5"	64.0	50.5	88.90	76.20
5012 02515	2.5"×1.5"	77.5	50.5	88.90	82.55
5012 02520	2.5"×2.0"	77.5	64.0	88.90	95.25
5012 03015	3.0"×1.5"	91.0	50.5	95.25	88.90
5012 03020	3.0"×2.0"	91.0	64.0	95.25	101.6
5012 03025	3.0"×2.5"	91.0	77.5	95.25	95.25
5012 04020	4.0"×2.0"	119.0	64.0	114.2	114.3
5012 04025	4.0"×2.5"	119.0	77.5	114.2	107.95
5012 04030	4.0"×3.0"	119.0	91.0	114.2	107.95

**T304 and T316L are available.

A9MP Equal Cross

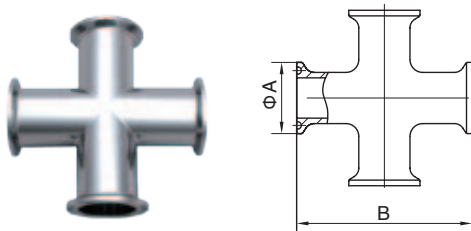

Basic Ordering Number: 5013

NO.	Size	A	B
5013 0100	1.0"	50.5	120.6
5013 0150	1.5"	50.5	139.8
5013 0200	2.0"	64.0	177.8
5013 0250	2.5"	77.5	177.8
5013 0300	3.0"	91.0	190.6
5013 0400	4.0"	119.0	228.4

**T304 and T316L are available.

A31-14MP Concentric Reducer

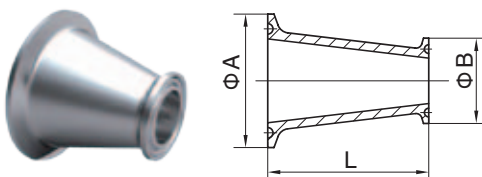

Basic Ordering Number: 5014

NO.	Size	A	B	L
5014 01510	1.5"×1.0"	50.5	50.5	76.2
5014 02010	2.0"×1.0"	64.0	50.5	127.0
5014 02015	2.0"×1.5"	64.0	50.5	76.2
5014 02510	2.5"×1.0"	77.5	50.5	177.8
5014 02515	2.5"×1.5"	77.5	50.5	127.0
5014 02520	2.5"×2.0"	77.5	64.0	76.2
5014 03010	3.0"×1.0"	91.0	50.5	282.5
5014 03015	3.0"×1.5"	91.0	50.5	177.8
5014 03020	3.0"×2.0"	91.0	64.0	127.0
5014 03025	3.0"×2.5"	91.0	77.5	76.2
5014 04015	4.0"×1.5"	119.0	50.5	282.5
5014 04020	4.0"×2.0"	119.0	64.0	231.7
5014 04025	4.0"×2.5"	119.0	77.5	180.9
5014 04030	4.0"×3.0"	119.0	91.0	130.1

**T304 and T316L are available.

NOTE! Treatment: Annealed.

**All measurements are in millimeters (mm)
Conversion to inches, 25.4mm=1inch

S-Line fittings

Part for ASTM A270 tubes

Finish: OD: Semi bright. ID: Mirror
Connections: Clamp ends



A32-14MP Eccentric Reducer

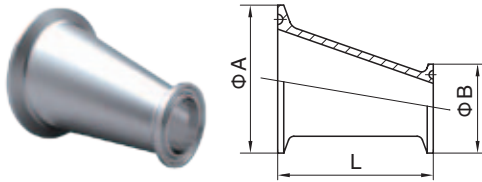

Basic Ordering Number: 5015

NO.	Size	A	B	L
5015 01510	1.5"×1.0"	50.5	50.5	76.2
5015 02010	2.0"×1.0"	64.0	50.5	127.0
5015 02015	2.0"×1.5"	64.0	50.5	76.2
5015 02510	2.5"×1.0"	77.5	50.5	177.8
5015 02515	2.5"×1.5"	77.5	50.5	127.0
5015 02520	2.5"×2.0"	77.5	64.0	76.2
5015 03010	3.0"×1.0"	91.0	50.5	282.5
5015 03015	3.0"×1.5"	91.0	50.5	177.8
5015 03020	3.0"×2.0"	91.0	64.0	127.0
5015 03025	3.0"×2.5"	91.0	77.5	76.2
5015 04015	4.0"×1.5"	119.0	50.5	282.5
5015 04020	4.0"×2.0"	119.0	64.0	231.7
5015 04025	4.0"×2.5"	119.0	77.5	180.9
5015 04030	4.0"×3.0"	119.0	91.0	130.1

**T304 and T316L are available.

L14AM Long Weld Ferrule

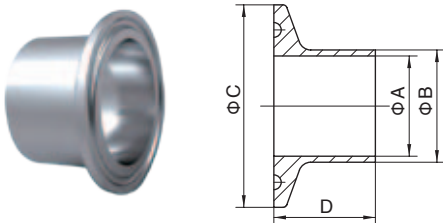

Basic Ordering Number: 5016

NO.	Size	A	B	C	D
5016 0050	0.5"	9.4	12.7	25.2	28.6
5016 0075	0.75"	15.75	19.05	25.2	28.6
5016 0100	1"	22.2	25.4	50.5	28.6
5016 0150	1.5"	34.8	38.1	50.5	28.6
5016 0200	2"	47.5	50.8	64.0	28.6
5016 0250	2.5"	60.2	63.5	77.5	28.6
5016 0300	3"	72.9	76.2	91.0	28.6
5016 0400	4"	97.38	101.6	119.0	28.6
5016 0600	6"	146.86	152.4	166.8	28.6
5016 0800	8"	97.66	203.2	217.7	28.6
5016 1000	10"	247.2	254.0	268.5	28.6
5016 1200	12"	298	304.8	319.3	28.6

**T304 and T316L are available.

14WMP Short Weld Ferrule

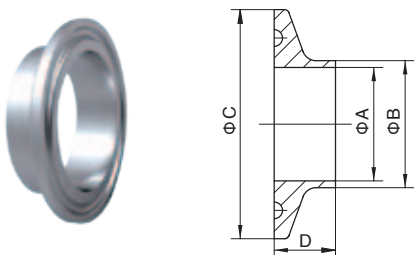

Basic Ordering Number: 5017

NO.	Size	A	B	C	D
5017 0050	0.5"	9.4	12.7	25.2	12.7
5017 0075	0.75"	15.75	19.05	25.2	12.7
5017 0100	1"	22.2	25.4	50.5	12.7
5017 0150	1.5"	34.8	38.1	50.5	12.7
5017 0200	2"	47.5	50.8	64.0	12.7
5017 0250	2.5"	60.2	63.5	77.5	12.7
5017 0300	3"	72.9	76.2	91.0	12.7
5017 0400	4"	97.38	101.6	119.0	15.8

**T304 and T316L are available.

NOTE! Treatment: Annealed.

**All measurements are in millimeters (mm)
Conversion to inches, 25.4mm=1inch

S-Line fittings

Part for ASTM A270 tubes



1.1

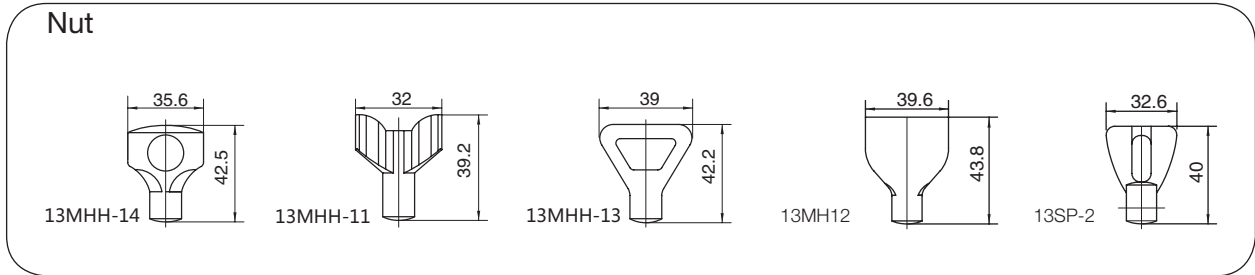

13MHHM** Double Hinge Heavy Duty Clamp

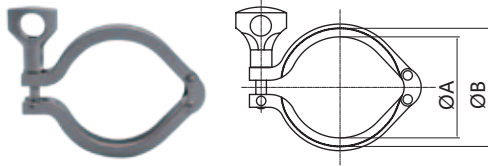

Basic Ordering Number: 5018

NO.	Size	A	B
5018 1015	1"-1.5"	44.4	53.6
5018 0200	2"	57.8	67
5018 0250	2.5"	71.4	80.6
5018 0300	3"	84	94.2
5018 0350	3.5"	99	109.2
5018 0400	4"	110	122.2
5018 0450	4.5"	123	133.2
5018 0600	6"	155.4	170.4

**Only T304 is available.

A13MHHM Single Hinge Heavy Duty Clamp

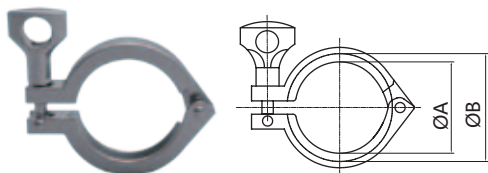

Basic Ordering Number: 5019

NO.	Size	A	B
5019 5075	0.5"-0.75"	20	28
5019 0150	1"-1.5"	44.4	53.6
5019 0200	2"	57.8	67
5019 0250	2.5"	71.4	80.6
5019 0300	3"	84	94.2
5019 0350	3.5"	99	109.2
5019 0400	4"	110	122.2
5019 0450	4.5"	123	133.2
5019 0600	6"	155.4	170.4
5019 0800	8"	205	220
5019 1000	10"	257	272
5019 1200	12"	308	323

**Only T304 is available.

NOTE!

**All measurements are in millimeters (mm)
Conversion to inches, 25.4mm=1inch

S-Line fittings

Part for ASTM A270 tubes



13MHHS / A13MHHS** Fractional Clamp

Basic Ordering Number: 5020

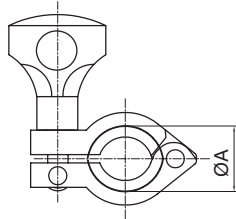

NO.	Size		A	
	in	mm	in	mm
5020 0075	0.75	19.0	1.13	28.6

**Only 1.4301 is available.

13MHHS 3-Segment Heavy Duty Clamp

Basic Ordering Number: 5021

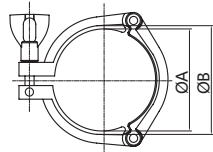

NO.	Size	A	B
5021 1015	1"-1.5"	44.4	53.6
5021 0200	2"	57.8	67
5021 0250	2.5"	71.4	80.6
5021 0300	3"	84	94.2
5021 0350	3.5"	99	109.2
5021 0400	4"	110	122.2
5021 0450	4.5"	123	133.2
5021 0600	6"	155.4	170.4

**Only T304 is available.

13MHP High Pressure Clamp

Basic Ordering Number: 5022

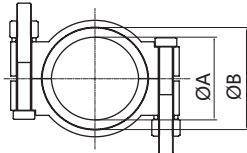

NO.	Size	A	B
5022 1015	1"-1.5"	44.4	53.6
5022 0200	2"	57.8	67
5022 0250	2.5"	71.4	80.6
5022 0300	3"	84	94.2
5022 0350	3.5"	99	109.2
5022 0400	4"	110	122.2
5022 0450	4.5"	123	133.2
5022 0600	6"	155.4	170.4

**Only T304 is available.

NOTE!

**All measurements are in millimeters (mm)
Conversion to inches, 25.4mm=1inch

S-Line fittings

Part for ASTM A270 tubes



Finish: OD: Semi bright. ID: Semi bright
Connections: Clamp ends

1.1

40MP Gasket

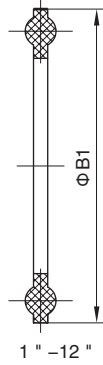

Basic Ordering Number: 5023

NO.	Size	B1
5023 5075	0.5"-0.75"	21.8
5023 1050	1"-1.5"	50.5
5023 0200	2"	64
5023 0250	2.5"	77.5
5023 0300	3"	91
5023 0400	4"	119
5023 0450	4.5"	130
5023 0600	6"	166.8
5023 0800	8"	217.7
5023 1000	10"	268.5
5023 1200	12"	319.3

**Silicone, EPDM, FPM and PTFE are available.

16AMP Solid End Cap

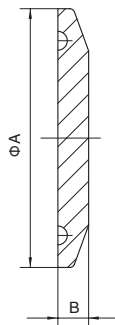

Basic Ordering Number: 5024

NO.	Size	A	B
5024 5075	0.5"-0.75"	25.2	6.4
		34	6.4
5024 1050	1"-1.5"	50.5	6.4
5024 0200	2"	64.0	6.4
5024 0250	2.5"	77.5	6.4
5024 0300	3"	91.0	6.4
5024 0400	4"	119.0	7.9
5024 0600	6"	166.8	11.1
5024 0800	8"	217.7	11.1
5024 1000	10"	268.5	11.1
5024 1200	12"	319.3	11.1

**T304 and T316L are available.

NOTE! Treatment: CNC Finished

**All measurements are in millimeters (mm)
Conversion to inches, 25.4mm=1inch

WELD FITTINGS

Weld to the ASTM A270 tubing

1.1



Removal from the system is not required
EACH FITTINGS PACKAGING HAS A BARCODE

WELD FITTINGS....

1.1

Weld fittings give processors the highest degree of corrosion resistance and sanitation available. Their streamlined design, flush joints and butt-weld assembly provides full, unrestricted flow for truly hygienic, permanent welded systems.

GEMO Weld Fittings meet



requirements

WELD FITTINGS SPECIFICATIONS....

- Size Range: 1/2" OD through 12" OD
- Materials: T304, T316L
- Surface Finish:
 - Mechanically Polished
 - Internal 20Ra (0.51µm), External 32Ra (0.8µm)
 - No. 7 - ID & OD
 - No. 5 - OD only
 - No. 3 - ID only
 - No. 1 - unpolished
 - Custom - built upon request

Example

Description	Item No	Size	Material	Surface	Quantity
A2WK bend	5025	2"	T304	NO.7	200

NOTES THE DIMENSION TABLES

- All Dimensions are in mm.
- Wall Thickness: Fittings 1.0"-3.0" sizes are manufactured with 16 gauge (0.065") wall thickness. The 4.0" tube size is manufactured with 14 gauge (0.083") wall thickness.



ORDERING SPECIFICATIONS....

- Specify:
- Description
 - Item No.
 - Size
 - Material
 - Surface Polish Requirements
 - Quantity

Weld Fittings

Part for ASTM A270 tubes



TUBES AND FITTINGS **GEMO**

Finish: OD: Semi bright. ID: Mirror
Connections: Welding ends

1.1

A2WK Bend 45°, No Tangent

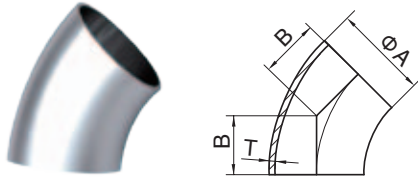

Basic Ordering Number: 5025

NO,	Size	A	B	T
5025 0100	1.0"	25.4	15.8	1.65
5025 0150	1.5"	38.1	23.8	1.65
5025 0200	2.0"	50.8	31.75	1.65
5025 0250	2.5"	63.5	39.6	1.65
5025 0300	3.0"	76.2	47.6	1.65
5025 0400	4.0"	101.6	63.5	2.11

**T304 and T316L are available.

AL2WS Bend 45°

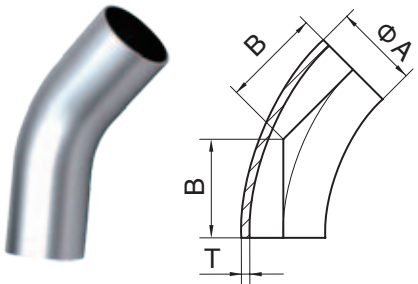

Basic Ordering Number: 5026

NO.	Size	A	B	T
5026 0100	1.0"	25.4	30.2	1.65
5026 0150	1.5"	38.1	41.3	1.65
5026 0200	2.0"	50.8	58.7	1.65
5026 0250	2.5"	63.5	76.2	1.65
5026 0300	3.0"	76.2	93.7	1.65
5026 0400	4.0"	101.6	122.2	2.11

**T304 and T316L are available.

A2WCL Bend 90°, No Tangent

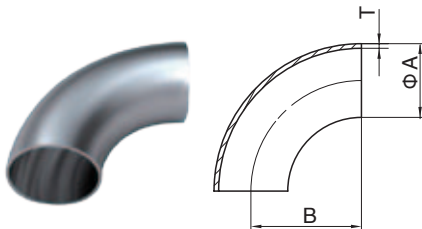

Basic Ordering Number: 5027

NO.	Size	A	B	T
5027 0100	1.0"	25.4	38.1	1.65
5027 0150	1.5"	38.1	57.2	1.65
5027 0200	2.0"	50.8	76.2	1.65
5027 0250	2.5"	63.5	95.25	1.65
5027 0300	3.0"	76.2	114.3	1.65
5027 0400	4.0"	101.6	152.4	2.11

**T304 and T316L are available.

NOTE! Treatment: Annealed.

**All measurements are in millimeters (mm)
Conversion to inches, 25.4mm=1inch

Weld Fittings

Part for ASTM A270 tubes



TUBES AND FITTINGS **GEMO**

Finish: OD: Semi bright. ID: Mirror
Connections: Welding ends

1.1

AL2S Bend 90°

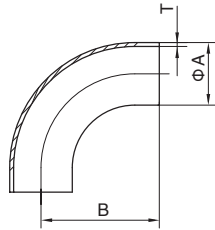

Basic Ordering Number: 5028

NO.	Size	A	B	T
5028 0100	1.0"	25.4	52.4	1.65
5028 0150	1.5"	38.1	74.6	1.65
5028 0200	2.0"	50.8	103.2	1.65
5028 0250	2.5"	63.5	131.8	1.65
5028 0300	3.0"	76.2	160.3	1.65
5028 0400	4.0"	101.6	211.1	2.11

**T304 and T316L are available.

AL7WWW Equal Tee, No Tangent

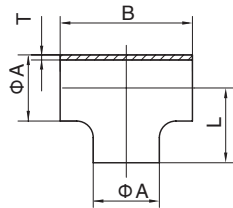
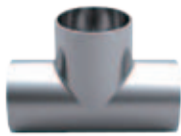

Basic Ordering Number: 5029

NO.	Size	A	B	L	T
5029 0100	1.0"	25.4	57.2	28.6	1.65
5029 0150	1.5"	38.1	84.2	42.1	1.65
5029 0200	2.0"	50.8	104.8	52.4	1.65
5029 0250	2.5"	63.5	119.0	59.5	1.65
5029 0300	3.0"	76.2	131.8	65.9	1.65
5029 0400	4.0"	101.6	174.6	87.3	2.11

**T304 and T316L are available.

A7W Equal Tee

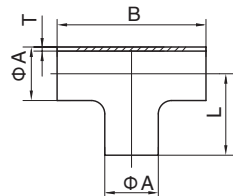
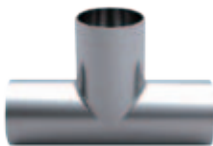

Basic Ordering Number: 5030

NO.	Size	A	B	L	T
5030 0100	1.0"	25.4	95.2	47.6	1.65
5030 0150	1.5"	38.1	114.3	57.2	1.65
5030 0200	2.0"	50.8	152.4	76.2	1.65
5030 0250	2.5"	63.5	152.4	76.2	1.65
5030 0300	3.0"	76.2	165.2	82.6	1.65
5030 0400	4.0"	101.6	196.8	98.4	2.11

**T304 and T316L are available.

NOTE! Treatment: Annealed.

**All measurements are in millimeters (mm)
Conversion to inches, 25.4mm=1inch

Weld Fittings

Part for ASTM A270 tubes



Finish: OD: Semi bright. ID: Mirror
Connections: Welding ends

AL7RW Reducing Tee

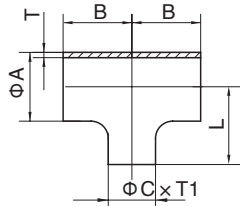
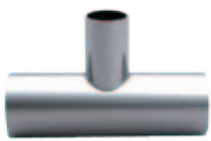

Basic Ordering Number: 5031

NO.	Size	A	C	B	L	T	T1
5031 01510	1.5"×1.0"	38.1	25.4	57.15	53.98	1.65	1.65
5031 02010	2.0"×1.0"	50.8	25.4	76.2	60.30	1.65	1.65
5031 02015	2.0"×1.5"	50.8	38.1	76.2	63.50	1.65	1.65
5031 02515	2.5"×1.5"	63.5	38.1	76.2	69.85	1.65	1.65
5031 02520	2.5"×2.0"	63.5	50.8	76.2	82.55	1.65	1.65
5031 03015	3.0"×1.5"	76.2	38.1	82.55	76.2	1.65	1.65
5031 03020	3.0"×2.0"	76.2	50.8	82.55	88.9	1.65	1.65
5031 03025	3.0"×2.5"	76.2	63.5	82.55	82.55	1.65	1.65
5031 04020	4.0"×2.0"	101.6	50.8	98.4	101.6	2.11	1.65
5031 04025	4.0"×2.5"	101.6	63.5	98.4	95.25	2.11	1.65
5031 04030	4.0"×3.0"	101.6	76.2	98.4	95.25	2.11	1.65

**T304 and T316L are available.

A9WWWW Equal Cross

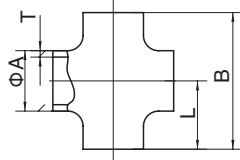

Basic Ordering Number: 5032

NO.	Size	A	B	L	T
5032 0100	1.0"	25.4	57.2	28.6	1.65
5032 0150	1.5"	38.1	84.2	42.1	1.65
5032 0200	2.0"	50.8	104.6	52.4	1.65
5032 0250	2.5"	63.5	119.0	59.5	1.65
5032 0300	3.0"	76.2	131.8	65.9	1.65
5032 0400	4.0"	101.6	174.6	87.3	2.11

**T304 and T316L are available.

L31 Concentric Reducer

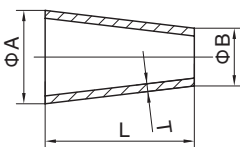

Basic Ordering Number: 5033

NO.	Size	A	B	L	T
5033 01510	1.5"×1.0"	38.1	25.4	50.8	1.65
5033 02010	2.0"×1.0"	50.8	25.4	101.6	1.65
5033 02015	2.0"×1.5"	50.8	38.1	50.8	1.65
5033 02510	2.5"×1.0"	63.5	25.4	152.4	1.65
5033 02515	2.5"×1.5"	63.5	38.1	101.6	1.65
5033 02520	2.5"×2.0"	63.5	50.8	50.8	1.65
5033 03010	3.0"×1.0"	76.2	25.4	203.2	1.65
5033 03015	3.0"×1.5"	76.2	38.1	152.4	1.65
5033 03020	3.0"×2.0"	76.2	50.8	101.6	1.65
5033 03025	3.0"×2.5"	76.2	63.5	50.8	1.65
5033 04015	4.0"×1.5"	101.6	38.1	254.0	2.11
5033 04020	4.0"×2.0"	101.6	50.8	203.2	2.11
5033 04025	4.0"×2.5"	101.6	63.5	152.4	2.11
5033 04030	4.0"×3.0"	101.6	76.2	101.6	2.11

**T304 and T316L are available.

NOTE! Treatment: Annealed.

**All measurements are in millimeters (mm)
Conversion to inches, 25.4mm=1inch

Weld Fittings

Part for ASTM A270 tubes

Finish: OD: Semi bright. ID: Mirror
Connections: Welding ends



1.1

L32 Eccentric Reducer

Basic Ordering Number: 5034

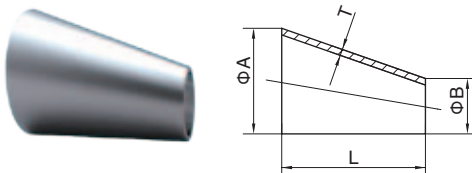

NO.	Size	A	B	L	T
5034 01510	1.5"×1.0"	38.1	25.4	50.8	1.65
5034 02010	2.0"×1.0"	50.8	25.4	101.6	1.65
5034 02015	2.0"×1.5"	50.8	38.1	50.8	1.65
5034 02510	2.5"×1.0"	63.5	25.4	152.4	1.65
5034 02515	2.5"×1.5"	63.5	38.1	101.6	1.65
5034 02520	2.5"×2.0"	63.5	50.8	50.8	1.65
5034 03010	3.0"×1.0"	76.2	25.4	203.2	1.65
5034 03015	3.0"×1.5"	76.2	38.1	152.4	1.65
5034 03020	3.0"×2.0"	76.2	50.8	101.6	1.65
5034 03025	3.0"×2.5"	76.2	63.5	50.8	1.65
5034 04015	4.0"×1.5"	101.6	38.1	254.0	2.11
5034 04020	4.0"×2.0"	101.6	50.8	203.2	2.11
5034 04025	4.0"×2.5"	101.6	63.5	152.4	2.11
5034 04030	4.0"×3.0"	101.6	76.2	101.6	2.11

**T304 and T316L are available.

**All measurements are in millimeters (mm)
Conversion to inches, 25.4mm=1inch

P&E Flow Technology Profile

P&E Flow Technology is provider of professional products for the fluid industry and related solutions.

We are committed to brew processing, beverage processing, Dairy and Foodstuff processing, pharmaceutical industry, water treatment works, Bio-engineering and fluid technology industry

P&E Flow Technology Brands

CKAN

ZIMANI

GEMO

Meatier

Shst

How to contact P&E Flow Technology
www.pestainless.com

GEMO Products Services
Please visit and contact us:
www.gemoindustries.com

Technical Support
Tech@gemoindustries.com

Service
Info@gemoindustries.com

Dealer Management
DealerManagement@gemoindustries.com

P&E Flow Technology

Address: Shacheng Street, WenZhou, P.R China.
Post Code: 325000

Service, Sales
Tel: +86-577-85826961
Email: Info@pestainless.com

Dealer Management
Email: DealerManagement@pestainless.com

Copyright © 2011 P&E

GEMO is a trademark registered and owned by P&E Flow Technology. P&E reserves the right to change specifications without prior notify action.